

Haier

Laundry Centre

CLC108GNU1



**Download
the hOn
Smart-Home App.**



Instruction manual

- Please read this manual carefully before use
- The company reserves the right to interpret the instructions
- Please refer to the actual product for the appearance of the product
- Please keep it properly after reading
- In case of product technology or software upgrades, no further notice will be given

Thank you for purchasing a Haier Product.

Please read these instructions carefully before using this appliance. The instructions contain important information which will help you get the best out of the appliance and ensure safe and proper installation, use and maintenance.

Keep this manual in a convenient place so you can always refer to it.

If you sell the appliance, give it away, or leave it behind when you move house, make sure you also pass this manual so that the new owner can become familiar with the appliance and safety warnings.



Legend

Warning! – Important Safety information



General information and tips



Environmental information



Warning: Risk of fire/Flammable materials



Read the instructions



Disposal

Help protect the environment and human health. Put the packaging in applicable containers to recycle it. Help to recycle waste of electrical and electronic appliances. Do not dispose appliances marked with this symbol with the household waste. Return the product to your local recycling facility or contact your municipal office for advice on adequate disposal.



Content

Safety information.....	3
Product description.....	10
Installation.....	12
Technical data.....	17
Control panel	19
hOn App	24
Programmes	27
Preparation.....	30
Eco-friendly washing	36
Care and cleaning	37
Troubleshooting	41
Customer service.....	45

Before switching on your appliance for the first time, read and save this guide.



WARNING!

Meaning of symbols on the Washer-dryer



Warning: Risk of fire/Flammable materials



Read the instructions

Before first use

- ▶ Do not operate this machine if it has been damaged during transport. Contact your dealer or Haier service technician.
- ▶ Ensure all transport bolts are removed before running the appliance. Failure to do so might end in damage to the appliance.
- ▶ Remove all packaging and keep out of reach of children.
- ▶ This appliance is heavy, we recommend 2 people to move and install the appliance.
- ▶ This product has been designed for personal, family or household use. This product is not designed for any commercial use. Any commercial use will terminate this products manufacturer's warranty.

Daily use

- ▶ This appliance is not intended for use by persons (including children) with reduced physical, sensory or mental capabilities, or lack of experience and knowledge, unless they are supervised or given instructions on how to use it by someone responsible for their safety.
- ▶ Supervise children to ensure they do not play with the appliance or climb inside the drum.
- ▶ Do not swing on or put weight on the door.
- ▶ The appliance should only be used for garments recommended for machine washing/drying. Always follow the advice on the care label.

1- Safety information



WARNING!

Daily use

- ▶ Do not touch or operate the machine with wet hands or with bare-feet.
- ▶ Do not place dripping wet clothing in or on top of the appliance as it may create an electrical hazard.
- ▶ Do not use the appliance if industrial chemicals (e.g. solvents) have been used on the clothes.
- ▶ Remove all items such as lighters and matches from pockets.
- ▶ Pull up zips, fix loose threads and protect embellishments to prevent garments from being damaged and entangled.
- ▶ Garments that contain metal reinforcements should not be placed in the appliance. If necessary, use an appropriate laundry bag or net.
- ▶ The appliance might get hot during operation, use caution if in close proximity.
- ▶ Unplug the appliance before undertaking maintenance. Hold the plug (not the cable) when unplugging the machine.
- ▶ Ensure there are no undesirable objects inside the drum before starting a cycle.
- ▶ Ensure that the ambient temperature is between 5°C and 35°C before using the appliance.

Capacity

Do not overload the appliance beyond its rated capacity:

- ▶ MAXIMUM WASH/DRY CAPACITY: 10/8 Kg.
- ▶ Capacity refers to the maximum dry weight of items the appliance can wash/dry at any one time.



WARNING!

Washer Information

- ▶ Do not open the detergent dispenser drawer during a cycle.
- ▶ Do not force the door to open. The door is fitted with a self-lock mechanism that will disengage upon cycle completion. In the event of a power failure the door may remain locked, refer to Section 8 of the user guide for instructions on how to open the door.
- ▶ If a high wash temperature is selected, the door glass will become hot. Do not touch the surface and keep children away from the appliance.
- ▶ Do not add petrol, dry-cleaning solvents, perfumes or other flammable or explosive substances to the wash water. These substances give off vapours that could ignite or explode.
- ▶ Do not wash articles that have been previously cleaned in, washed in, soaked in, or spotted with gasoline, dry-cleaning solvents, or other flammable or explosive substances as they give off vapours that could ignite or explode.
- ▶ Do not wash an electric blanket in your washer unless the care label specifically states it is safe to do so.
- ▶ Fabric softeners, or similar products, should be used as specified by the manufacturer instructions.

Dryer Information

- ▶ Ensure all lint filters are cleaned before every load.
- ▶ Do not operate this product without the lint filter in place or allow lint to accumulate in or around the appliance.
- ▶ If the lint filter is damaged, contact your Haier service technician to arrange getting a new filter. Do not operate your appliance with a damaged lint filter or without the filter in place, as this will cause damage to your appliance.

1- Safety information



WARNING!

Dryer Information

- ▶ If ducting the dryer to the outdoors, ensure adequate ventilation is provided during operation of the appliance to avoid any backflow of gases from fuel burning appliances.



WARNING: The last stage of the drying cycle is a cool down phase. Never stop a tumble clothes appliance before the end of the cycle unless all items are removed and spread out in order to dissipate the heat.

- ▶ Do not dry items which are unwashed.
- ▶ Do not dry items which have been cleaned with industrial chemicals.
- ▶ Items that have previously been cleaned in, washed in, soaked in or spotted with flammable liquids or solids, eg petrol/gasoline, kerosene, dry cleaning solvents, vegetable or cooking oil, acetone, denatured alcohol, some brands of spot removers, turpentine, waxes and wax removers or other flammable or explosive substances should not be placed in a tumble dryer.
- ▶ Rubber backed articles, foam rubber (latex foam), clothes or pillows fitted with foam rubber pads, fibreglass, shoes containing rubber, plastic, shower caps, babies waterproof napkin covers and waterproof textiles should not be dried in the dryer. These materials can when heated produce fire by spontaneous combustion.
- ▶ Do not dry an electric blanket or any other electrical items in your dryer, unless the care label specifically states it is safe to do so. Never dry these items at high temperatures.
- ▶ Fabric Softeners or similar products should not be used in a tumble dryer to eliminate the effects of static electricity, unless this practice is specifically recommended by the manufacturer of the fabric softener product.



WARNING!

Dryer Information

- ▶ Oil-affected items can ignite spontaneously, especially when exposed to heat sources such as a tumble appliance. The items become warm causing an oxidation reaction in the oil. This oxidation creates heat. If the heat cannot escape the items can become hot enough to catch fire. Piling, stacking or storing oil-affected items can prevent heat from escaping creating a fire hazard.
- ▶ If it is unavoidable that fabrics that contain vegetable oil, cooking oil or have been contaminated by hair care products be placed in the appliance, they should first be washed in hot water with extra detergent – this will reduce, but not eliminate the fire hazard. The cool down cycle of the appliance should be used to reduce the temperature of these items. They should not be removed from the tumble appliance and piled or stacked while hot.

Maintenance, Cleaning and Disposal

- ▶ Keep the gasket, dispenser and door clean to prevent odours.
- ▶ Do not use water spray or steam to clean the appliance.
- ▶ A damaged electrical cable must be replaced by a Haier service technician or similarly qualified person. Do not use the appliance until it has been repaired to avoid a risk of electric shock.
- ▶ The only user-removable parts of the appliance are Lint Filter, Secondary filter, detergent dispenser, Shoe rack, Atomizer nozzle.
- ▶ When disposing of the appliance, it is recommended that the door is removed to avoid children getting trapped inside, and that the electrical cable is cut off close to the machine.
- ▶ Unless the product is modified by an approved technician, any changes might result in loss of warranty.

1- Safety information

Installation



WARNING! Electric Shock Hazard Failure to follow this advice may result in electric shock or death.

- ▶ Ensure that the appliance cable is positioned so that it does not come into contact with water or moisture.
- ▶ The appliance must not be supplied through an external switching device, such as a timer, or connected to a circuit that is regularly switched on and off by a utility.
- ▶ Install the appliance in a well-ventilated, dust-free environment.
- ▶ This appliance must not be installed or operated on a plinth (other than a genuine Haier part, installed per the instructions).
- ▶ We do not recommend the use of extension cords or portable electrical outlet devices.
- ▶ Ensure the installation provides accessibility to the plug or incorporate a switch in the fixed wiring in accordance with the wiring rules to allow disconnection of the appliance from the supply after installation.
- ▶ Review the electrical information on the rating plate before plugging this appliance to make sure the right voltage and current can be supplied.
- ▶ Install the appliance on a solid and level surface ensuring it has 20mm clearance on each side. The appliance must not be installed on any textured floor coverings (eg carpet, rugs).
- ▶ New hose sets provided with the appliance should be used to connect it to the water mains. Old hose sets should not be reused.
- ▶ We recommend to replace the inlet hoses (if any) every 5 years.
- ▶ **WARNING:** Failure to do so may result in a flood and damage to property.
- ▶ Do not expose the appliance to frost, external heat sources or direct sunlight.



WARNING!

Installation

- ▶ Do not install the appliance in a location where the ambient temperature drops below 5°C.
- ▶ Do not install the appliance outdoors or in a damp location.

Appliances connected to water mains.

Water supply requirements:

- ▶ Inlet water pressure: Max. 1MPa (145psi), Min. 50kPa (7.25psi)
- ▶ Inlet water flow rate: Min. 6 litres/minute
- ▶ A pressure-reducing valve must be installed if pressure is higher than 1MPa.
- ▶ For optimum wash performance check the supply pressure is within the recommended range.

Intended Use

- ▶ This appliance is intended for washing/drying garments that can be tumbled.
- ▶ Follow the manufacturer instructions found in the garment label.
- ▶ Do not make any changes or modifications to this appliance, they might cause personal injury and damages to property.

Dryer Information

- ▶ Do not install the appliance behind a lockable door, sliding door, or behind a door where the hinge is on the opposite side to that of the dryer in such a way that the full opening of the door is inhibited. Ensure the dryer door can always be opened fully.
- ▶ If installed behind a cabinetry door, it must be hinged on the same side as the dryer with a minimum clearance of 30mm from the dryer handle to the internal surface of the cabinetry door. The cabinetry door must remain open while the machine is running.
- ▶ Exhaust air must not be discharged into a flue which is used for exhausting fumes from appliances burning gas or other fuels.

2-Product description



Note:

Due to technical changes and different models, the illustrations in the following chapters may differ from your model.

2.1 Picture of appliance

Front (Fig. 2-1):

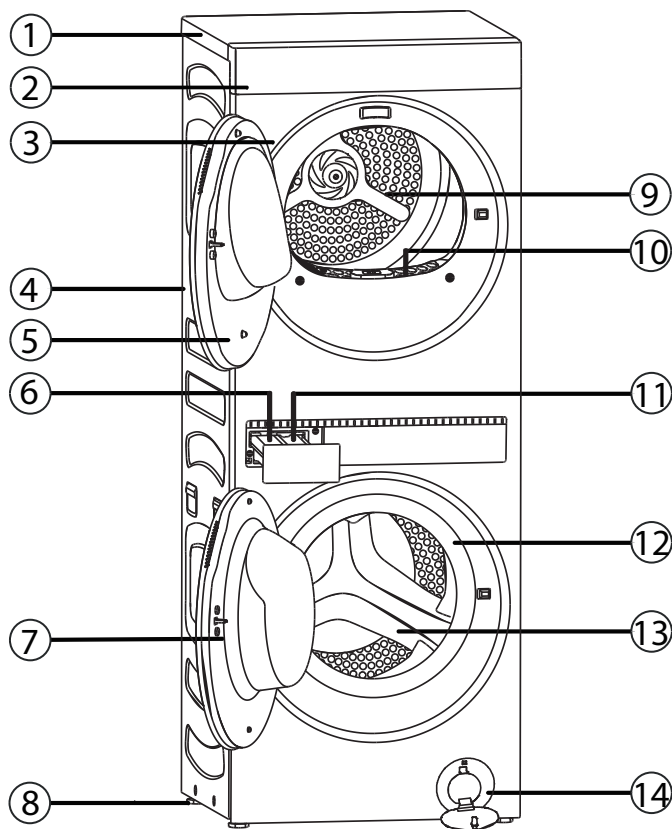

2-1

- 1 Countertop
- 2 Display control panel
- 3 Front plate
- 4 Lateral plate
- 5 Upper drum door
- 6 Detergent dispenser
- 7 Lower drum door

- 8 Adjustable Feet×4
- 9 Upper drum opening
- 10 Upper Drum Lint Filter
- 11 Softener Dispenser
- 12 Lower drum gasket
- 13 Lower drum opening
- 14 Drain filter door

Rear side (Fig. 2-2):

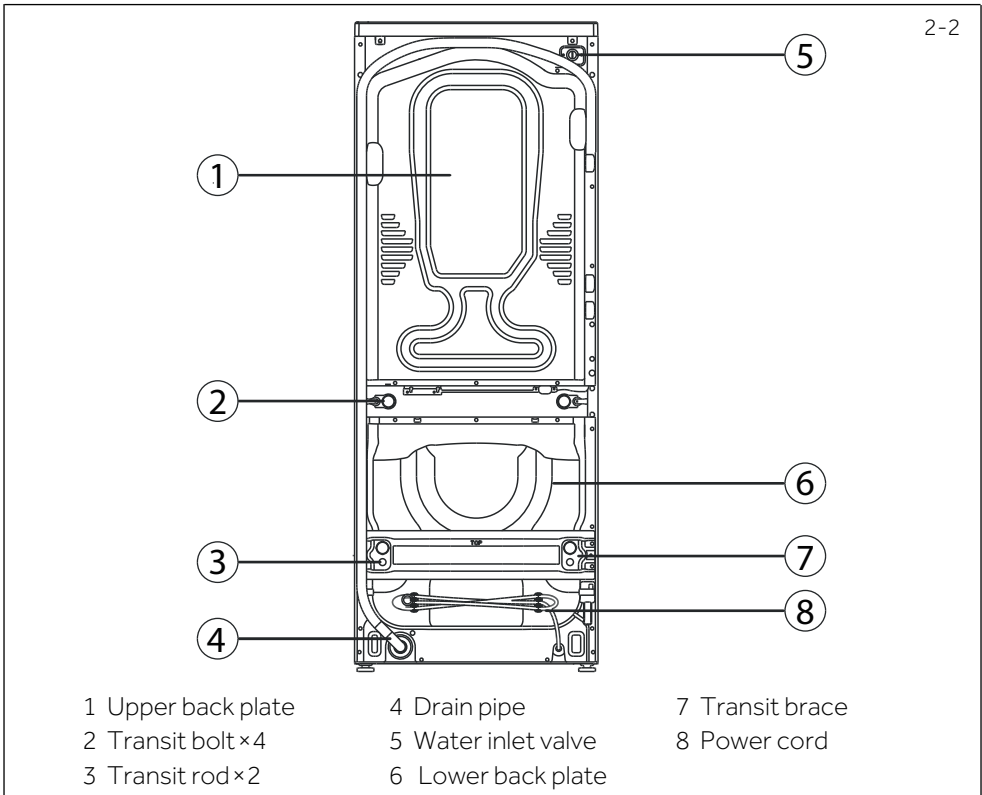

2.2 Accessories

Check the accessories and literature in accordance with this list (Fig. 2-3):

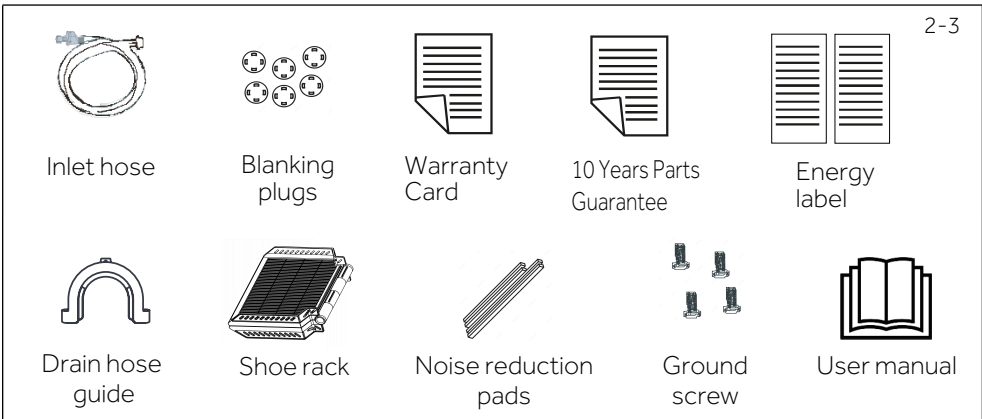

3-Installation

3.1 Unpacking

Your washer is heavy. We recommend two people to remove the packaging.

1. Remove the outer packaging including the polystyrene packer and plastic wrapping.
2. Lift the washer off the base.
3. Remove all packaging and accessories from inside the drum.
4. Dispose of all packaging sustainably, ensuring these materials are kept out of the reach of children.

3.2 OPTIONAL: Install noise reduction pads

1. When opening the shrink package, you will find four noise reduction pads. These are used for reducing noise (Fig. 3-1).
2. Lay the washing machine down to its side, porthole pointing upwards, bottom side towards operator (Fig. 3-2).
3. Take out the noise reduction pads and remove the double-sided adhesive protective film; paste around the bottom; the noise reduction pads under the washing machine cabinet as shown in Fig. 3-3 (two shorter pads in position 1 and 3, two longer pads in position 2 and 4). Finally set the machine upright again.

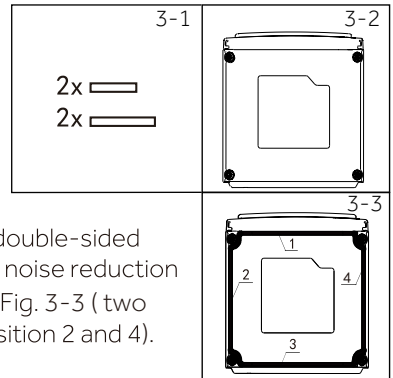

3.3 Removing Transit Safety Bolts

The detailed operations are as follows (Fig. 3-7) :

1. Use a spanner or socket to unscrew and remove all 4 transit bolts at the back of the washer (refer to A). Pull the black rubber grommets to remove the bolt, grommet and white plastic spacers from the machine (refer to B).
2. Remove the 4 transit brace screws from the left and right sides (refer to C). Remove the braces (refer to D) .
3. Remove (pull out) the two transit rods located below the two lower transit bolt holes (refer to E).
4. Cover the transit bolt holes with the plastic plugs (provided). Push to clip into place (refer to F).

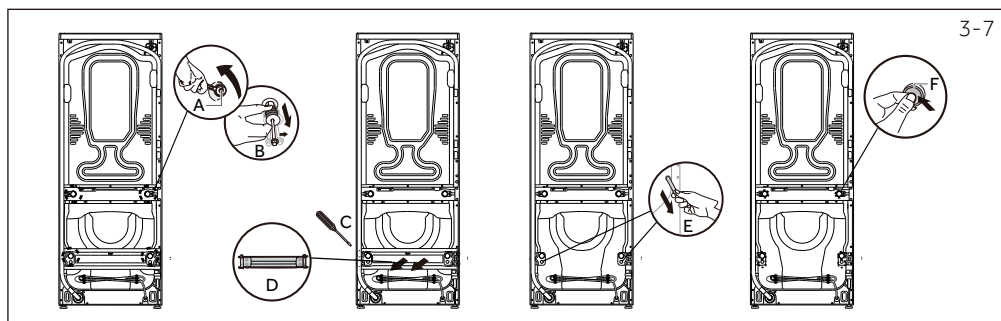

Note: Keep in safe place

Keep all the parts for later use. If the appliance needs to move location, reinstall the braces, rods and bolts in reverse order .

3.4 Leveling the appliance

Before positioning your washer in its final position, allowing for required clearances, check that it is level (Fig. 3-8) .

Level the washer side to side:

Place the level on the centre front of the washer. If you need to adjust the washer's position, loosen the lock nut using the spanner provided and turn the feet up or down until level. To wind the feet up turn clockwise, to wind the feet down turn counter-clockwise.

Level the washer front to back:

Place the level on the left side, in line with the centre of the washer. Adjust the front left foot and then the right foot until the washer is level.

There should be equal weight on both front feet.

Recheck the washer is level, front to back and side to side.

Repeat the above steps if required.

Using the spanner provided, tighten the lock nuts against the base of the washer to lock the feet in position.

Move and centre the washer back into its final position using adjacent walls as a guide.

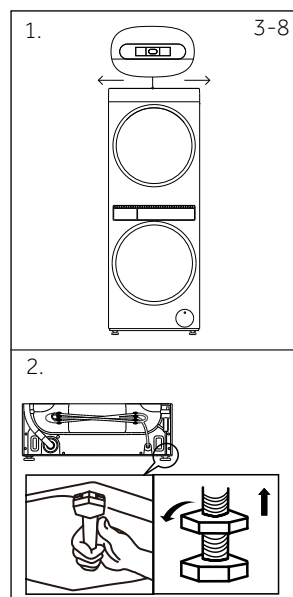

3-Installation

3-9

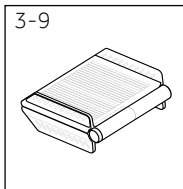

3.5 Install drying support (if required)

The drying bracket (Fig. 3-9) is mainly used to dry shoes and some clothes that are not suitable for turning in the dryer to reduce the damage to shoes and specific clothes.

Method of mounting bracket:

1. First, fold the drying stand and place it in the upper drum dryer;
2. Then unfold the drying bracket and lay it flat on the wall of the dryer cylinder.(Fig.3-10)

3-10

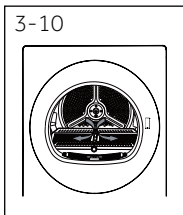

3-11

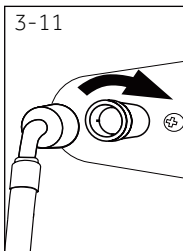

3.6 Connect to inlet hose

1. Connect the straight ends of the inlet hose(s) to the tap(s)
There are washers fitted in both ends.
2. Connect the elbow ends to the corresponding washer inlet valves (Fig. 3-11). If present the hot valve is coloured orange to make this easier.
3. Tighten the inlet hose(s) ends by hand until the hose seal just makes contact with the tap-sealing face(Fig. 3-12).
Continue to tighten a further half-turn.
4. Make sure there are no kinks in the hose(s).
5. Turn the tap(s) on and check for leaks. Check for leaks again after 24 hours.

3-12

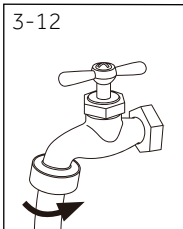

3.7 Drain hose

In multi-storey apartments or any upper floor, the washer should be installed on a floor equipped with a drain. Draining must comply with local by-laws.

Place the drain hose in a tub or standpipe

The hose guide is used to hold the drain hose over the tub or standpipe (Fig. 3-13).

1. Flex the guide apart and pull the hose through the guide.
2. Ensure a maximum of 20mm of the hose is left exposed at the end. The end of the drain pipe shall not be immersed in water.
3. Secure the hose guide to prevent it dislodging from the standpipe or tub.

If the drain hose is placed on the ground or if the tub or standpipe is less than 800mm high, the washer will continuously drain (siphon) while being filled.

Tub or standpipe height should be a minimum of 800mm and maximum of 1000mm.

Regularly check that your tub or standpipe is free from lint or other obstructions. This may affect operation or cause flooding.

Attach drain hose to spigot





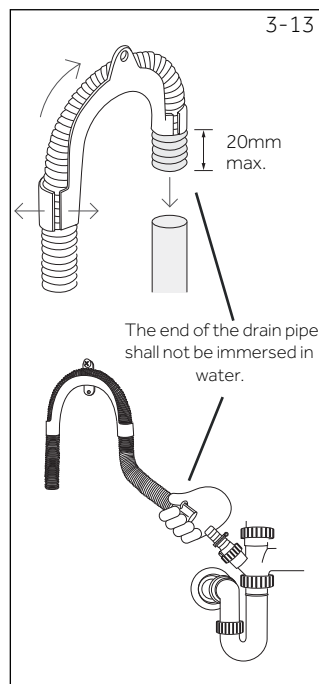

The hose guide is used to hold the drain hose high enough to prevent continuous draining (siphoning).

1. Flex the guide apart and pull the hose through the guide.
2. Secure the hose guide to a wall or the back wall of the cupboard using a screw.
3. Drill out the blanking insert from spigot to ensure the washer can drain correctly.
4. Attach drain hose to spigot and secure using a hose clamp.
5. Check for leaks.



3-Installation

3.8 Complete your installation

1. Press  to activate your washer. And select the Lower Drum.
2. Select a "Quick 15'" cycle. Ensure the drum is empty and the door closed.
3. Press  to start. The washer will start to fill.
4. Wait until you see water in the bottom of the drum.
5. Press  to stop the cycle, then press  to turn the washer off.
6. Press  again, select the "Spin" cycle and touch . Check the drain hose is firmly secured to the standpipe or tub, or spigot. Observe that the washer pumps out the water, and spins. The washer will beep to signal the end of the cycle. Any faults will be displayed on the screen, refer to Fault codes:

3.9 Final Checklist

Check you have done everything you need to before you start your first wash:

Have the packaging and transit bolts been removed?

- 1 Is the washer correctly levelled, feet are extended and cabinet corners are clear of the floor?
- 2 Is the drain hose threaded through the hose guide 'U bend' (with no more than 20mm extended) and hooked into your standpipe or tub, or attached to a spigot?
- 3 Have the taps been turned on?
- 4 Is the hot hose connected to the hot valve marked 'H'?
- 5 Is the cold hose connected to the cold valve marked 'C'?
- 6 Have you performed the test cycle? Refer to 'Complete your installation' section above.
- 7 Has the power cord been connected to an appropriate power supply and the power turned on?
- 8 Complete your first cycle with a half-load amount of detergent and without a load in order to remove any residues remaining in the washer from the manufacturing process.

4.1 Additional technical data

	CLC108GNU1
Amps (maximum)	10A
Volts (V)	220-240V
Hz	50Hz
Rated Power (W)	2000W

4.2 Product dimensions

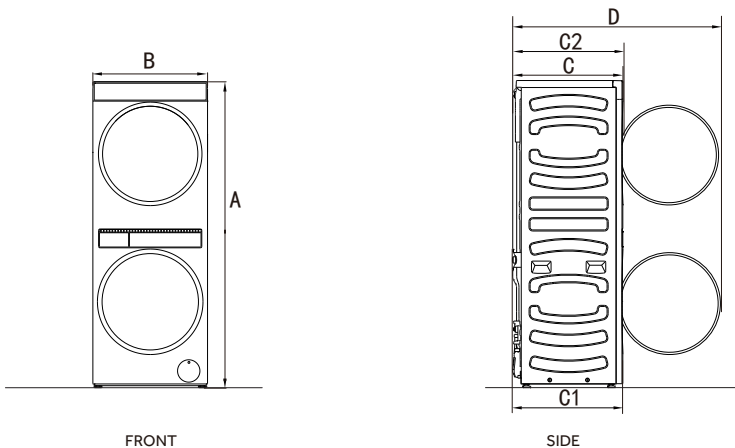

PRODUCT DIMENSIONS		MM
A	Overall height*	1600
B	Overall width	600
C	Depth of top	575
D	Depth of open door	1083
C1	Depth of bottom	570
C2	Overall depth**	592
Standpipe height min.		600

*Exact height is dependent on foot adjustment

**Including dial and door (when closed)

4-Technical data

4.3 Cavity and clearance dimensions

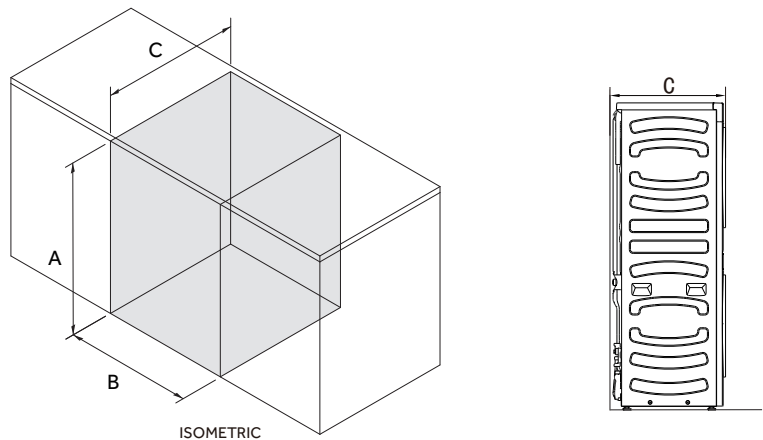

CAVITY DIMENSIONS		MM
A	Minimum cavity height	1620
B	Minimum cavity width	640
C	Minimum cavity depth	
%	Flush with front panel of the product*	610
%	In cupboard	645

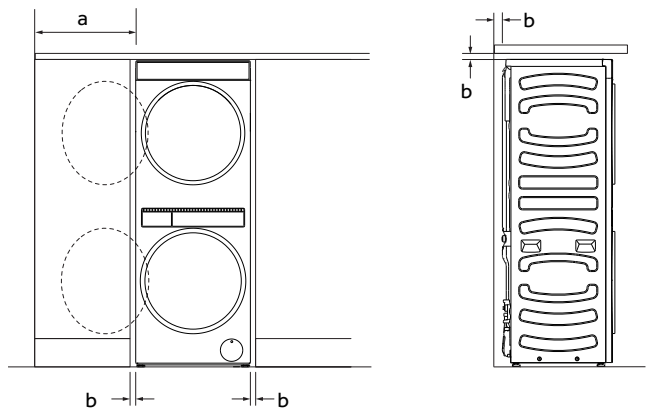

CLEARANCE DIMENSIONS		MM
a	Minimum washer door clearance to adjacent wall	200
b	Minimum gap clearance to adjacent product or cabinetry*	20

*Applies to sides, top and rear

5-Control panel

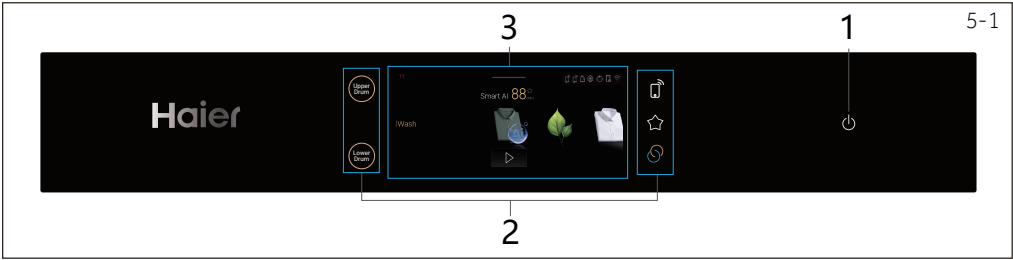

1."Power" button 2.The Touch screen 3.Function buttons outside the touch screen

5.1 "Power" Button

Press the Power button (Fig. 5-2) to turn ON and OFF the product. When on the display illuminates the default cycle and options; in dim light the displays shows possible modifiers and selectable options.



5.2 Function buttons outside the touch screen

Removing the operation inside the touch screen, there are 5 additional buttons available for operation outside the touch screen:

5.2.1 "Upper Drum" and "Lower Drum" button

Tap the "Lower Drum" icon (Fig. 5-3.1) to select the corresponding program and function of the lower drum, and adjust the parameters of the lower drum.

Tap the "Upper Drum" icon (Fig. 5-3.2) to select the program and function corresponding to the upper drum, and adjust the parameters of the upper drum. (After tapping the "Upper Drum" icon, touch the "Dry" on the touch screen to operate the drying program of the upper drum, and touch the "Nurse" on the touch screen to operate the clothing care program of the upper drum.)

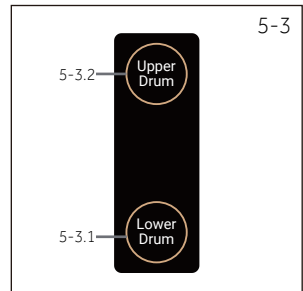

5.2.2 "Remote Control", "Star", and "Dry" button

Select the desired drum, and shortly press this button (Fig. 5-4.1) to activate/deactivate the Remote Control of the appliance via the hOn App (fig. 5-4.1).

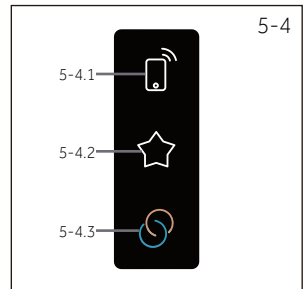

NOTE: To start the pairing procedure, please follow the App instructions. More information, please see the dedicated "hOn App" chapter 6.

Tap the "☆" icon on the program selection interface, and the icon will change to "★", indicating that the selected program and its configuration have been bookmarked. By tapping the "☆" icon (Fig. 5-4.2) on the right side of the touch screen, the previously bookmarked program and program configuration can be displayed. Press the "▶" key at this time, and the program will run according to the parameters set by the original bookmark. Only one set of parameters can be collected for the same program. Only one set of parameters can be collected for the same program.

5-Control panel

Use the Smart-Combi function to preheat the dryer drum and remove the need for select dry programme. When the desired wash cycle is selected, press the "S" button (Fig. 5-4.3) to turn on the feature before starting the cycle. The cycle selected will be automatically selected for the dry function and the upper dryer drum will preheat during the last 15 minutes of the wash cycle. When your washing has finished, Load the clothes into the dryer drum and run the drying program.

*Some programs cannot be selected, please refer to the actual interface display.

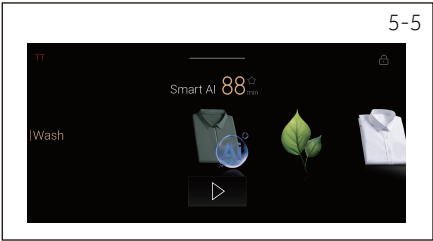

5-5

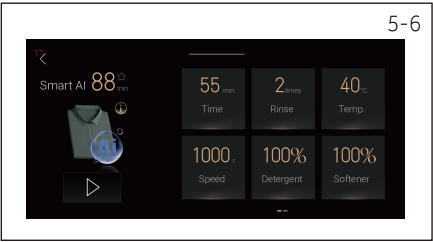

5-6

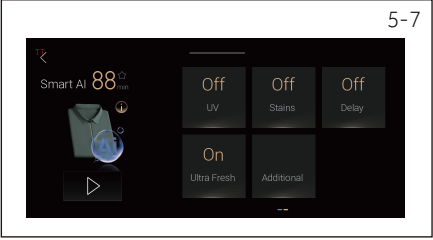

5-7

5.3 The Touch screen

This product adopts full touch screen control. The upper drum is used for drying and laundry care, and the lower drum is used for laundry. By sliding or touching the display screen, you can select the laundry program, drying program, and laundry care program and complete parameter settings(Fig. 5-5). Each drum can only run one program, and can use both laundry and drying programs at the same time, but cannot use both drying and laundry care programs at the same time.

the display shows following information :

- Washing / Drying time
- End time delay
- Error codes and service information
- Function buttons
- Speed, Temperature, etc

5.3.1Washing program selection and parameter setting

According to the daily laundry situation of the family, the lower drum is equipped with 16

washing programs. After selecting the program, the user can touch the "▷" button below the program to start the program. Alternatively, the user can enter the parameter setting interface by touching the program icon to modify the washing parameters(Fig. 5-6)(Fig. 5-7). The adjustable program parameters include:

"Time" adjustment: Adjust the washing time of the program.It needs to be adjusted after "Temp."

"Rinse" Adjustment: Adjust the number of rinses,It can be adjusted up to 5 times.

"Temp." Adjustment: Adjust the temperature of water heating.

"Speed" adjustment: Adjust the dehydration speed.

"Detergent" Adjustment: Adjust the amount of detergent, the small icon in the upper right corner can display the remaining amount of detergent in the dispenser and medium detergent. When the gear is adjusted to "OFF", the detergent dispensing

"Softener" Adjustment: Adjust the amount of fabric softener, the small icon in the upper right corner can display the distributor and the remaining fabric softener. When the gear is adjusted to "OFF", the fabric softener dispensing function is turned off.

"UV" adjustment: During washing and rinsing, turn on and off the UV treatment function. Using the UV treatment function will reduce bacteria and microorganisms in the water, providing a cleaner and sterile washing environment.

"Stains" adjustment: Select the type of stain to be washed on the clothes.

"Delay" Adjustment: Set the start time of the washing delay. Avoid using it on damp and color-resistant items

This function, because it may cause dye loss.

Adjustment of "Ultra Fresh": Turn on or off the breathing window function. Use the breathing window function to exchange the air inside the cylinder with the outside air, effectively eliminate odors, ensure fresh air inside the cylinder, and avoid mold on clothes.

"Additional" adjustment: Some additional features selected:

Water plus, increase the water level and amount during washing and rinsing.

Intensive, increase washing time, suitable for washing dirty clothes.

Soak, increase soaking time, suitable for washing dirty clothes.

Night wash, suitable for washing clothes at night. When the "Night wash" function is turned on, the washing machine's prompt sound will be turned off, and pressing the "Buttun Sound" button will not turn on the sound at this time.

Energy plus, energy-saving, suitable for washing less dirty clothes.

Anti-allergy, increase washing water temperature, sterilize and remove mites.

*Different programs have different program parameters to choose from, please refer to the actual interface display.

5.3.2 drying program selection and parameter setting

According to the daily laundry situation of the family, 16 drying programs are set on the drum. After selecting the program, the user can touch the "▷" button below the program to start the program(Fig. 5-8). Alternatively, the user can enter the parameter setting interface by touching the program icon to modify the drying parameters. (Fig. 5-8)The adjustable program parameters include:

"Dry Level" Adjustment: Adjust the dryness of the program to dry clothes. There are a total of four gears to choose from: "Ready to iron", "Ready to wear", "Cupboard", and "Extra dry".

"Temp." Adjustment: Adjust the ambient temperature in the drying drum. There are three gears to choose from: "Low", "Medium" and "High".

"Flexy Air" Adjustment: Adjust the wind speed in the drum when drying clothes. There are 5 levels to choose from.

"Delay" adjustment: Set the time to delay the start of the drying program.

*Different programs have different program parameters to choose from, please refer to the actual interface display.

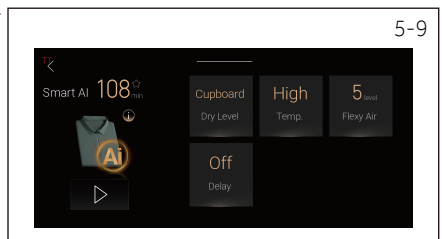
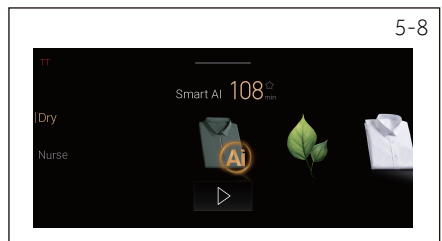

5-Control panel

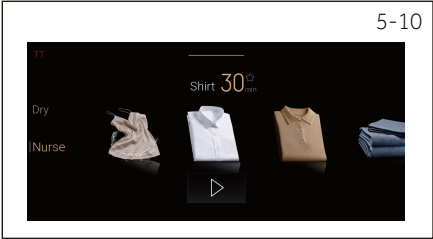

5.3.3 clothing care program selection and parameter setting

According to the scene of daily household clothing care, there are 6 clothing care programs set up on the upper drum. After selecting the program, users can touch "▷" below the program to start the program; (Fig. 5-10)they can also enter the parameter setting interface by touching the program icon to modify the drying parameters(Fig. 5-11). Adjustable program parameters include: "Time" Adjustment: Adjust the time for program care of clothing.

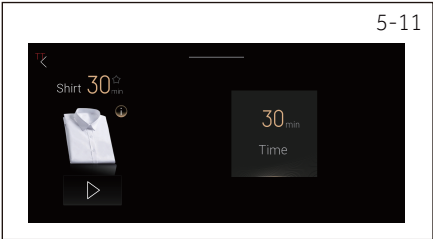

*Different programs have different program parameters to choose from, please refer to the actual interface display.



5.4 Drop-down menu settings

By swiping down the "—" on the screen, you can bring up the drop-down menu for additional settings(Fig. 5-12). There are a total of 9 settings to choose from (Fig. 5-13)(Fig. 5-14).

"Button Sound" button: the prompt sound of turning on or off the machine. When the icon displays "🔊", it indicates that the prompt sound is on. At this time, pressing the button on the machine and the end of the program or alarm will produce a prompt sound. When the icon displays "🔇", it indicates that the silent mode is turned on. At this time, pressing the button on the machine and the end of the program or alarm will not produce a prompt sound. Restarting the machine will continue the previous settings until this button is reset.

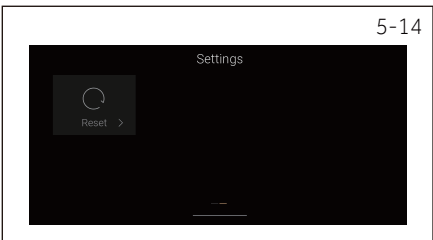
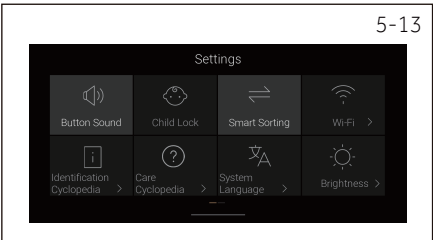

"Child Lock" button: Turn on or off the child lock, touch the icon, and when the icon background turns light gray, it means that the child lock function has been turned on. At this time, only the power button can be operated. If a fault alarm occurs, you can operate to confirm the fault alarm information. After the program ends, the child lock will be automatically released. If the child lock function is not turned off in the settings interface, the child lock function will be turned on by default the next time the program runs. After running the program for 1 minute, the child lock will continue to be enabled. In the child lock state, if the child lock function is no longer needed, press and hold the child lock function according to the screen prompt for 3 seconds to cancel the child lock lock, and then touch the child lock icon in the settings interface to turn off the child lock function. If the child lock function is not turned off in the settings interface and the screen is no longer operated. When the icon background turns dark gray, it indicates that the child lock function has been turned off.

"Smart Sorting" button: Turn on or off the smart sorting function, touch the icon, and when the icon background turns light gray, it means that the smart sorting function has been turned on. The system will sort the programs in the order displayed according to the user's usage frequency; the order of the upper drum drying program, the upper drum laundry care program, and the lower drum washing program are sorted respectively; when the icon background turns dark gray, it means that the smart sorting function has been turned off.

"Wi-Fi "button: It is used for resetting Wi-Fi credentials.

"Identification Cyclopedia" button: Pressing this button can display the meaning of some icons on clothing labels, and users can set the parameters of the program according to the instructions of the icons.

"Care Cyclopedia" button: Press this button to display relevant information about the installation, operation, maintenance, laundry care, and alarm of the laundry center.

"System Language" button: You can change the language of the operation interface.

"Brightness" button: used to change the brightness of the display screen, tapping or sliding left and right indicators can adjust the screen brightness.

"Reset" button: Press this button and then press "Reset" to restore the system to its factory state. This adjustment is irreversible.

6-hOn App

6.1 General Information

This appliance is equipped with Wi-Fi technology for remote control Via the hOn App.



WARNING!

Follow the safety precautions indicated in this manual even when using the appliance through the App. Adhering to these instructions is essential for safe use.

6.2 Requirements

1. **Wi-Fi Network:** A router compatible with 802.11b/g/n and 2.4 GHz band is required. Networks operating at 5 GHz and public networks are not supported. The network name (SSID) must be between 1 and 31 characters, and the password between 8 and 64 characters. Encryption options include open, WPA-PSK, and WPA2-PSK.

2. **Compatible Devices:** The App is available for Android, iOS, and Huawei devices, on both tablets and smartphones.

3. **Positioning:** Install the Appliance in an area with a strong Wi-Fi signal.

Wi-Fi Technical Specifications:

- Frequency: 2400 MHz - 2483.5 MHz
- Max Power: 20 dBm
- Standard: IEEE802.11b/g/n & **Bluetooth®** Low Energy v4.2¹

6.3 Download and Installation of the hOn App

There are two ways to get the hOn App:

1. From Your Smartphone's App Store

- Scan the QR code below or visit go.haier-europe.com/download-app.
- Follow your device's prompts to download and install.



Download the
hOn App



2. Directly from Your Appliance:

a. First Power-On:

1. Turn on the appliance.
2. Select your preferred language.
3. A QR code will appear on the display: scan it to download the hOn App.

b.Subsequent Power on:

1. Turn on the appliance.
2. Press the  button on the control panel.
3. A QR code will appear on the display: scan it to download the hOn App.

Note: Registration



Creating a profile (sign-up) is only required on first use or if your account has been deleted or disabled. For subsequent uses, simply log in with your email address and password. Use Demo mode in the App to explore the Wi-Fi features.

6.4 Appliance Pairing



Note: The home network must be set to 2.4 GHz; networks operating at 5 GHz are not supported. Ensure your smartphone is connected to the same 2.4 GHz Wi-Fi network you want to use to configure the appliance.

1. Open the hOn App, create a new profile (or log in if you already have one).
2. Tap "Add Appliance" and follow the on-screen instructions on your smartphone to complete the setup.

6.5 Remote Control activation for the lower drum

1. Ensure the router is powered on and connected to the Internet.
2. Load the laundry and close the door.
3. Turn on the appliance.
4. Press  button.
5. Short press the  button. The door will lock.
6. Start the cycle through the App.
7. Remote control can also be activated during the cycle by short pressing the  button.



6.6 Remote Control activation for the upper drum

1. Ensure the router is powered on and connected to the Internet.
2. Load the laundry and close the door.
3. Turn on the appliance.
4. Press  button.
5. Short press the  button.
6. Start the cycle through the App.
7. Remote control can also be activated during the cycle by short pressing the  button.



Note: Remote Control Expiration

You can send a command from the App up to 24 hours after Remote Control is enabled.

6.7 Remote Control deactivation for the lower drum

1. During a cycle, you can deactivate Remote Control by short pressing the  button; the cycle will continue. You can view the cycle status in the App but won't be able to send commands (e.g., stop/pause).
2. For the lower drum, if all safety conditions are met, you may open the door once the Remote Control function has been deactivated.
3. To resume remote control through the App, make sure the door is closed, then short press the  button again.

6.8 Remote Control deactivation for the upper drum

1. During a cycle, you can deactivate Remote Control by short pressing the  button; the cycle will continue. You can view the cycle status in the App but won't be able to send commands (e.g., stop/pause).
2. For the upper drum, you may open the door once the the Remote Control function has been deactivated.
3. To resume remote control through the App, make sure the door is closed, then short press the  button again.

6.9 End of Cycle with Remote Control

1. At the end of the cycle, the door can be opened if all safety conditions are met and the Remote Control is deactivated.
2. After 2 minutes, the appliance will automatically power off.

6.10 Turning Off Wi-Fi Module and Clearing Network Credentials

To delete the saved Wi-Fi network information and turn off the Wi-Fi module:

1. Make sure the appliance is powered on.
2. Without starting any cycle, go to the **appliance settings** menu.
3. Navigate to the **Wi-Fi section** and select the option to **reset Wi-Fi credentials**. The system will ask you to confirm the operation.
4. Tap **[Confirm]** to proceed with the reset, or **[Cancel]** to abort the operation.
5. The stored network information will be deleted. To exit, either select a wash program or power off the appliance.
6. To reconnect the appliance, remove it from the hOn App and start a new pairing procedure.





Note: Use this procedure only if you intend to sell the appliance.

¹ The **Bluetooth®** word mark and logos are registered trademarks owned by Bluetooth SIG, Inc., and any use of such marks by Candy Hoover Group Srl is under license. Other trademarks and trade names belong to their respective owners.

Wash Programme

Programme	Designed for	Max. load washing in kg	Wash temperature in °C	Spin speed in rpm
Smart AI	Suitable for intelligent washing of clothes made of cotton, linen, chemical fiber and other materials.	10	Cold,20,30,40,60	0,400,600,800,1000,1200
Eco 40-60	/	10	Cold,20,30,40,60	0,400,600,800,1000,1200,1400
Shirt	Machine-washable shirts made of Cotton or Cotton blends.	3	Cold,20,30,40	0,400,600,800,1000
Cotton	Normally soiled garments made of cotton fabrics.	10	Cold,20,30,40,60,90	0,400,600,800,1000,1200,1400
Synthetics	Suitable for washing chemical fiber clothing	5	Cold,20,30,40,60	0,400,600,800,1000,1200
Delicate	Suitable for washing ultra-gentle clothes.	3	Cold,20,30	0,400,600
Baby Care	Suitable for washing children's clothes that can be machine washed.	5	Cold,20,30,40,60,90	0,400,600,800,1000,1200
Allergy Care	Used for high-temperature mite removal and washing of cotton, linen, and chemical fiber clothing, not suitable for wool and silk clothing	5	Cold,20,30,40,60,90	0,400,600,800,1000,1200,1400
Quick 15'	Only suitable for washing cotton, linen, and chemical fiber clothes that are not too dirty.	1	Cold,20,30,40	0,400,600,800,1000,1200,1400
Wool	Suitable for washing machine-washable woolen clothing.	2.5	Cold,20,30,40	0,400,600,800
Spin	Only dehydrate and spin dry clothes	10	/	0,400,600,800,1000,1200,1400
Cotton 20°C	Normally soiled garments made of cotton fabrics.	10	20	0,400,600,800,1000,1200,1400
Bulky	Normally soiled bulky items such as jackets.	7	Cold,20,30,40,60	0,400,600,800,1000
Duvet	Suitable for washing machine-washable down clothes	2.5	Cold,20,30,40	0,400,600,800
Drum Clean	tra hot program to clean the washer.	/	90	/
Sports	Suitable for washing machine washable sports clothes	3	Cold,20,30,40	0,400,600,800,1000

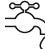
7-Programmes

Net Load	Programme	 (kg)	 (HH:MM)	ENERGY (kWh/Cycles)	 (L/Cycles)	Max Temperature (°C)	Effective Speed (U/Min)	 Rest Moisture Content(%)
10 kg	Eco 40-60	10.0	3:58	0.505	68.0	27	1330	53.0
	Eco 40-60	5.0	2:58	0.285	44.0	25	1330	53.0
	Eco 40-60	2.5	2:48	0.195	30.0	25	1330	55.0
	Cotton 20°C	10.0	0:53	0.300	80.0	20	1000	65.0
	Cotton 60°C	10.0	1:46	2.000	80.0	57	1330	55.0
	Wool 30°C	1.0	0:45	0.380	40.0	30	800	37.0
	Quick 15' 30°C	1.0	0:23	0.380	40.0	30	1000	65.0

Dry Programme

Programme	Designed for	Max. load drying, in kg
Smart AI	Autosensing cycle for garments made of cotton fabrics.	8
Eco	Energy efficient cycle	8
Shirt	Autosensing cycle for shirts that can be tumbled dry.	2.4
Cotton	Autosensing cycle for garments made of cotton fabrics.	8
Synthetics	Suitable for drying heat-resistant chemical fiber clothing.	3.2
Delicate	Gentle autosensing cycle for delicate garments.	3.2
Baby Care	Suitable for drying heat-resistant children's clothing.	3.2
Special Dry	Suitable for clothes that need rack drying.	1
Quick 30'	Suitable for fast drying of small amounts or lightweight chemical fiber or cotton clothing, with a short program time.	0.8
Wool	Suitable for drying machine washable wool clothing.	1
Timer	Suitable for timed drying of clothes that can be dried by a drum (except for silk, wool, and home textiles), the drying time can be selected according to the weight and moisture content of the clothes.	/
Outdoor	Suitable for drying outdoor clothing such as windbreakers that can be drum-dried.	2.5
Bulky	Suitable for drying machine washable large items of clothing.	4
Duvet	Suitable for drying machine washable down jackets and down vests that can be drum-dried.	2
Towel	Suitable for drying heat-resistant home textiles such as bath towels.	3.2
Sports	Suitable for drying machine washable sports clothing.	3.2

Nurse Programme

Programme	Designed for
Synthetics	Suitable for dust removal, odor removal, fluffy care and improvement of synthetic fiber.
Mix	Suitable for dust removal, odor removal, fluffy care and improvement of cotton and linen, synthetic fiber, etc.
Delicate	Suitable for dust removal, odor removal, fluffy care and improvement of light and fine clothes.
Shirt	Suitable for clothes warming, dehumidifying and improvement of cotton and cotton blended shirts.
Wool	Suitable for dust removal, odor removal, fluffy care and improvement of wools.
Bulky	Suitable for dust removal, mite removal, fluffy care and improvement of large items of clothing.

1. Please keep the clothes naturally stretched when putting them in.
2. Adult clothing is recommended to be cared for individually;
3. It is recommended that the amount of baby clothing should not exceed 5 pieces at a time.
4. Do not put in excessive or oversized fabrics, especially silk fabrics, silk quilts, etc.

In the program parameter selection interface, touch "ⓘ" on the program icon, click "ⓘ Program description" or ":- Washing suggestions" (":- Drying suggestions" for drying and clothing care programs) to display the program description and precautions. If there are any differences between the illustrated description in the manual and the entire machine, please refer to the description displayed on the entire machine.

Check the energy label for energy consumption information.

The actual energy consumption may differ from the declared one according to local conditions. Actual water temperature may differ from declared cycle temperature.

Woolmark Wool Care

The wool drying cycle of this machine has been tested and approved by The Wool-mark Company. The cycle is suitable to dry wool garments which are labelled "hand wash" provided that the garments are washed in a Woolmark endorsed hand washing cycle and dried according to the instructions issued by the manufacturer of this machine.M2505.

The wool wash cycle of this machine has been tested and approved by The Wool-mark Company for the washing of wool garments labelled as "hand wash" provided that the products are washed according to the instructions on the garment label and those issued by the manufacturer of this washing machine. M2421.



8-Preparation

8.1 Power supply

Connect the washing machine to a power supply (220V / 50Hz; Fig. 8-1). Please refer also to section Installation.

8.2 Water connection

- ▶ Before connecting check the cleanliness and clarity of the water inlet.
- ▶ Turn on the tap (Fig. 8-2).

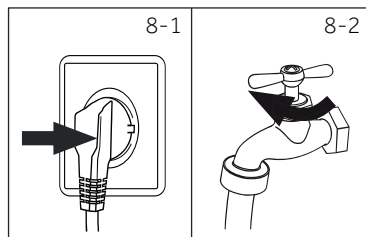

Note: Tightness

Before use check for leakage in the joints between the tap and the inlet hose by turning on the tap.

8.3 Wash Preparation



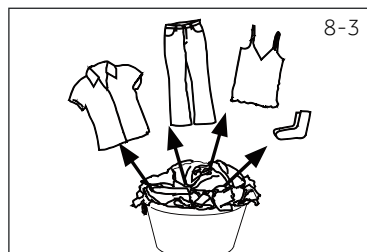

























- ▶ Sort out clothes according to fabric (cotton, synthetics, wool or silk etc.) and how dirty they are (Fig. 8-3). Pay attention to the care labelling of washing labels.
- ▶ Separate white clothes from coloured ones. Wash coloured textiles first by hand to check if they fade or run.
- ▶ Empty pockets (keys, coins, etc.) and remove



harder decorative objects (e.g. brooches) as well as flammable objects (paper tissues, lighters, matches etc.).

- ▶ Garments without hems, delicates and finely woven textile such as fine curtains are to be put into a wash bag to care for this delicate laundry (hand or dry cleaning would be better).
- ▶ Close zippers, velcro fastener and hooks, make sure the buttons are sewn on tightly.
- ▶ Place sensitive items like laundry without firm hem, delicate underwear (Dessous) and small items such as socks, belts, bras, etc. in a wash bag.
- ▶ Unfold large pieces of fabric such as bed sheets, bedspreads etc.
- ▶ Turn jeans and printed, decorated or color-intensive textiles inside out; possibly wash separately.

Care chart

Washing		
 Washable up to 95°C normal process	 Washable up to 60°C normal process	 Washable up to 60°C mild process
 Washable up to 40°C normal process	 Washable up to 40°C mild process	 Washable up to 40°C very mild process
 Washable up to 30°C normal process	 Washable up to 30°C mild process	 Washable up to 30°C very mild process
 Wash by hand max. 40°C	 Do not wash	
Bleaching		
 Any bleaching allowed	 Only oxygen/ non-chlorine	 Do not bleach
Drying		
 Tumble drying possible normal temperature	 Tumble drying possible lower temperature	 Do not tumble dry
 Line drying	 Flat drying	
Ironing		
 Iron at a maximum temperature up to 200 °C	 Iron at a medial temperature up to 150°C	 Iron at a low temperature up to 110°C; without steam (steam ironing may cause irreversible damage)
 Do not iron		
Professional Textile Care		
 Dry cleaning in tetrachloroethene	 Dry cleaning in hydrocarbons	 Do not dry clean
 Professional wet clean	 Do not professional wet clean	

8-Preparation

8.4 Loading the Lower washer drum

- ▶ Put in the laundry piece by piece.
- ▶ Don't overload. Note the different maximum load according to programmes!
Rule of thumb for maximum load: Keep six inches between load and drum top.
- ▶ Close the door carefully. Make sure that no pieces of laundry are pinched.



CAUTION!

Non-textile, as well as small, loose or sharp-edged items may cause malfunctions and damage of clothes and appliance.

8.5 Selecting detergent

- ▶ Washing efficiency and performance is determined by used detergent quality.
- ▶ Use only machine wash approved detergent.
- ▶ If needed use specific detergents, e.g for synthetic and woolen fabric.
- ▶ See tips for countertop detergent stickers.
- ▶ Do not use dry cleaning agents such as trichloroethylene and similar products.

8.6 Add detergent and softner

1. Press the distributor handle in the middle of the machine to pop out the distributor box(Fig.8-4).
2. Pull out the pop-up dispenser box to the appropriate position and lift the dispenser up from under the rubber soft plug by hand
At the bottom of the box, then pull out the dispenser box in the direction of the arrow (Fig.8-5).
3. Unscrew the cap of the dispenser box counterclockwise, add the special detergent and fabric softener to the corresponding dispenser box, tighten the cap clockwise, and pay attention to tightening the cap in place to avoid leakage(Fig.8-6).
4. After the addition is complete, reinstall the dispenser box into the dispenser box and then put the dispenser box back in place.



Note:

- ▶ Do not overuse detergent or softener.
Please follow the instruction on the detergent package.
- ▶ Always fill the detergent just before the beginning of the wash cycle.
- ▶ Concentrated liquid detergent should be diluted before adding.
- ▶ Carefully choose the programme settings according to the

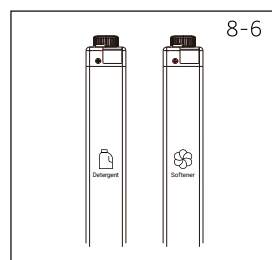
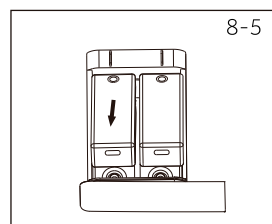
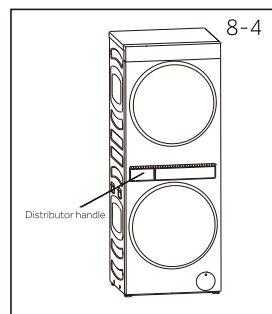



Note: First Wash

It is recommended before using the product to run a Cotton cycle with 95° C wash temp and 800 rpm spin speed without any load to reduce odors.

8.7 Ending a Wash cycle

When a wash cycle has finished it is recommended to remove the load as soon as possible to prevent additional wrinkling.

Open the door to prevent formation of moisture and odours.

To pause a cycle, press "||". The button will start flashing. Press it again to resume the cycle.

To end a cycle before it has finished, press "||" to pause the cycle then turn off the product by holding the "⏻" button for 2 seconds. If there is still water in the drum it is recommended to run "Spin" cycle to drain the water.



Note: Door lock

- ▶ For safety reason when a wash cycle is started the lower washer drum door is locked. It is only possible to open the door at the end of a cycle or when a cycle is canceled correctly and the product is in a safe state.
- ▶ The washing machine is in a safe state with water level below the window, the drum temperature below 55°C, and the drum not spinning.

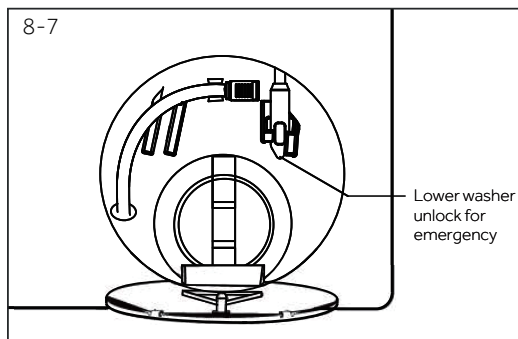

8.8 In an emergency

In an emergency (such as a power failure), you can manually open the door lock to remove your load.

If the water level of the lower drum wash machine is higher than the opening of the door, first drain the water from the bucket. See the process described in "Pump filter". Open the drain filter door (Fig.8-7) and pull the lever until the door is unlocked with a gentle click.



Note: Standby-mode

To save energy the product will enter standby-mode and the display will turn off after 2 minutes of inactivity.

8-Preparation

8.9 Dryer Preparation

Sort items into loads of similar items, and loads that will likely take similar times to dry. This prevents the possibility of some items becoming over-dried whilst others are still damp. Separate coloured items from white/light items where possible, especially when new. Colour run may be an issue, especially if you intend to delay the start of the drying cycle. Care labels on garments provide valuable information about the fabric type and how the garment should be dried. Always follow the advice on garment labels.

Item/drying requirements	Suggested cycle	Comments
Towels	Towels	Towels produce a lot of lint and are best dried on their own.
Sheets, pillowcases	Bedding	Ensure openings are buttoned/domed before placing in the dryer.
Delicates, fine fabrics	Delicate	You can further reduce the dryness level to damp for very delicate items.
Mixed clothes	Cotton or Synthetic	Ensure the items can safely withstand heat.

8.10 Before you load

- ▶ Check pockets for items that could damage your clothes or get caught in the dryer. Close zippers, hooks and eyes, and other fastenings (ie fasten the openings of duvet/ doona covers), and remove loose brawires. These may damage both your dryer and your clothes.
- ▶ Items of clothing with screen-printing should be turned inside out to prevent damage to the print.
- ▶ Check the lint filter is clean.

8.11 Loading

- ▶ Garments need to be loaded correctly to minimise creasing and wrinkling, and to ensure the load is dried evenly.
- ▶ Allow enough room in the dryer for clothes to tumble freely. Load the dryer in terms of the space the garments take up when dry, rather than when they are wet.
- ▶ Shake clothes out and load individually to help items dry evenly and reduce tangling.
- ▶ Dry permanent press garments (business shirts) together on the Damp dryness level with Anti-crease option on. This will help reduce wrinkling and the need for ironing.
- ▶ Hang garments as soon as the drying cycle is complete to reduce the need for ironing.

8.12 Drying times

- ▶ Drying very small loads is inefficient. Try to dry medium to large loads.
- ▶ Heavier items (towels, flannelette sheets) will take longer to dry than light item (synthetics and polyester cotton sheets and shirts).
- ▶ Drying times can be reduced by spinning the wash load at the highest spin speed suitable for the load type in your washing machine
- ▶ Check bulky items during the cycle to ensure even drying, pause the dryer and reposition the item if necessary.

8.13 Lint

Some items are lint givers, while others are lint collectors. Always dry lint givers and collectors separately.

Lint givers	Lint collectors
Towels	Synthetics, eg polar fleece
Flannelette sheets	Corduroy
	Polyester cottons

Delicate or easily damaged items (eg nylon stockings, fine fabrics, delicate embroidered fabrics) should be dried separately, using the "Delicate" cycle.

9-Eco-friendly washing



Environmentally responsible use

Washing

- ▶ To achieve best use of energy, water, detergent and time you should use the recommended maximum load size.
- ▶ Do not overload (hand width clearance above laundry).
- ▶ For slightly soiled laundry select the "Quick 15' " programme
- ▶ Choose the lowest adequate washing temperature-modern detergents are efficiently cleaning below 60°C.
- ▶ Raise default settings only due to heavy staining.
- ▶ Spin the laundry with the maximum spin speed if you want to use a drying programme afterwards.

Drying

- ▶ It is recommended to use the maximum load size.
- ▶ Loosen up the laundry before starting the drying programme.



WARNING!

- ▶ Before cleaning and maintenance, remove the power plug from the socket.
- ▶ After cleaning and maintenance, reinstall the components in reverse order.

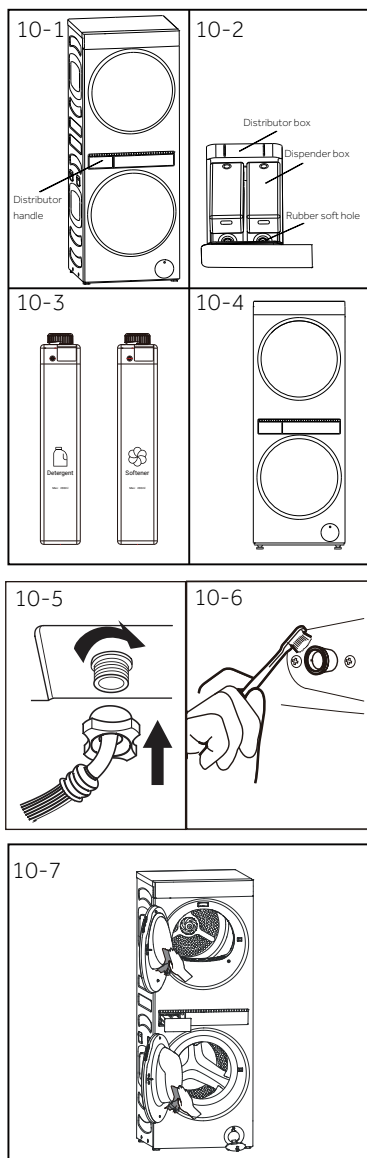

10.1 Cleaning the detergent drawer

- ▶ Press the distributor handle in the middle of the machine to pop out the distributor box (Fig. 10-1).
- ▶ Pull the pop-up dispenser box to the appropriate position, lift the bottom of the dispenser box from below the rubber soft plug by hand, and then pull out the dispenser box in the direction (Fig. 10-2).
- ▶ Hold the lower auxiliary pressing area of the distributor box with your hand (Fig. 10-3), gently tilt the collar upward, and then pull out the distributor box to the outside of the machine.
- ▶ Rinse the inside of the dispenser box with water, and wipe the outside of the dispenser box and the outside of the dispenser box with a towel.
- ▶ Use a towel to wipe the inside of the slot on the machine clean.
- ▶ Return the dispenser box and dispenser box to their original positions.

10.2 Cleaning the machine

- ▶ Unplug the machine during cleaning and maintenance.
- ▶ Use a soft cloth with soap liquid to clean the machine case (Fig. 10-4) and rubber components.
- ▶ Do not use organic chemicals or corrosive solvents.

10.3 Water inlet valve and inlet valve filter

To prevent blockage of water supply by solid substances like lime clean regularly the inlet valve filter.

- ▶ Unplug the power cord and turn off the water supply.
- ▶ Unscrew the water inlet hose at the back (Fig. 10-5) of the appliance as well as on the tap.
- ▶ Flush the filters with water and a brush (Fig. 10-6).
- ▶ Insert the filter and install the inlet hose.

10.4 Cleaning the drum

- ▶ Remove accidentally washed items, especially metal parts such as pins, coins, etc. from the drum (Fig. 10-7) because they cause rust stains and damage.
- ▶ Use a non-chloride cleaner for removing rust stains. Observe the warning hints of the cleaning agent manufacturer.
- ▶ Do not use any hard objects or steel wool for cleaning.

10-Care and cleaning

10.5 Clean the upper drum lint filter

10.5.1 Clean primary filter

To ensure good drying results, clean the primary filter before or after each cycle.

1. Open the upper drum door (Fig. 10-8).
2. Remove the primary filter from the machine (Fig. 10-9).
3. Open the filter (Fig. 10-10).
4. Use a wet towel to clean up the fluff and lint residuals on each mesh (Fig. 10-11).

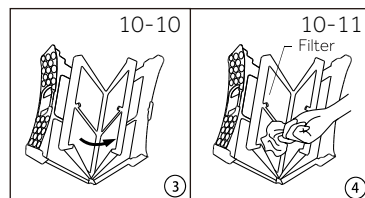
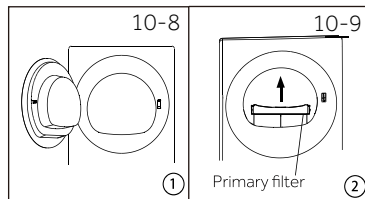

WARNING!

- If you rinse the filter with water, make sure that the surface of the filter is dry or wiped dry before putting it back in place.
- When cleaning the primary filter, clean the dust around the filter seal, drying door glass, drying air duct, and other corners.

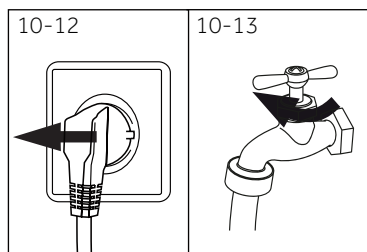

10.6 Long periods of disuse

If the appliance is left idle for a longer period:

1. Pull out the electrical plug (Fig. 10-12).
2. Turn off water supply (Fig. 10-13).
3. Open the door to prevent formation of moisture and odours. Let the door open while not used. Before next usage check carefully the power cord, water inlet and drain hose. Make sure everything is properly installed and without leakage.

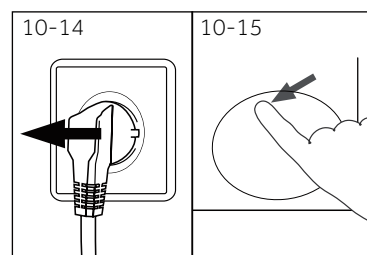

10.7 Pump filter

Clean the filter once a month and check the pump filter for instance if the appliance:

- ▶ Doesn't drain the water.
- ▶ Doesn't spin.
- ▶ Cause unusual noise while running.



WARNING!

Scalding Risk! Water in the pump filter can be very hot! Before any action please ensure water has cooled down.

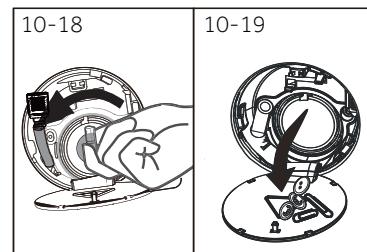
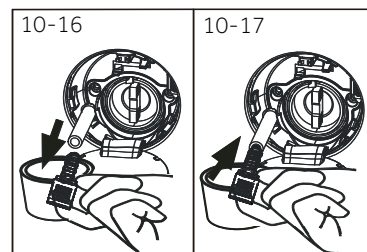

1. Turn off and unplug the machine (Fig. 10-14).
2. Push and open service flap (Fig. 10-15).
3. Provide a flat container to catch leach water (Fig. 10-16). There could be bigger amounts!
4. Pull the drain hose out and hold its end above the container (Fig. 10-16).
5. Take the sealing plug out of the drain hose (Fig. 10-16).
6. After complete drainage close drain hose (Fig. 10-17). and push it back into the machine.
7. Unscrew and remove counter clockwise the pump filter (Fig. 10-18).
8. Remove contaminants and dirt (Fig. 10-19).

10-Care and cleaning

9. Clean carefully pump filter, e.g. using running water (Fig. 10-20).
10. Refix it thoroughly (Fig. 10-21).
11. Close service flap.

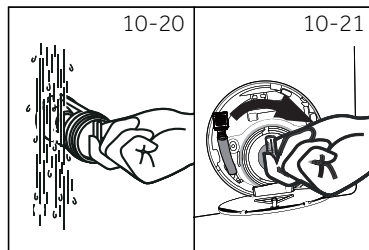

Many occurring problems could be solved by yourself without specific expertise. In case of a problem please check all shown possibilities and follow below instructions before you contact an after sales service. See CUSTOMER SERVICE.



WARNING!

- ▶ Before maintenance, deactivate the appliance and disconnect the mains plug from the mains socket.
- ▶ Electrical equipment should be serviced only by qualified electrical experts, because improper repairs can cause considerable consequential damages.
- ▶ A damaged power cable should only be replaced by the manufacturer, its service agent or similarly qualified persons in order to avoid a hazard.

11.1 Troubleshooting with display code

Problem	Cause	Solution
CLr FLtr	<ul style="list-style-type: none">• Drainage anomaly.	<ul style="list-style-type: none">• Check whether the drainage pipe is blocked or bent. Check and clean the drain filter.
E2	<ul style="list-style-type: none">• Door lock abnormal	<ul style="list-style-type: none">• If the program has just started phase and the door is not locked, close the door again and press the start button.• At the end of the program, if the door is not unlocked, please cut off the water and power and contact the maintenance personnel.
E4	<ul style="list-style-type: none">• Abnormal water intake, faucet not on or off water.	<ul style="list-style-type: none">• Please check whether the faucet is turned on, the water pressure is too low, or the water is cut off.
FH	<ul style="list-style-type: none">• The wireless module fails to be configured.	<ul style="list-style-type: none">• Power on the washing machine again, press the power button to turn it on.



Note:

When a continuous series of beeps sound, a string of codes appears on the display a fault has occurred'. Please call your trained and supported Haier service technician.

11-Troubleshooting

11.2 Troubleshooting without display code

Problem	Appliance fails to operate.
Cause	a. Programme is not yet started. b. Door is not properly closed. c. Machine has not been switched on. d. Power failure. e. Key lock is activated.
Solution	a. Check programme and start it. b. Close the door properly. c. Switch the machine on. d. Check power supply. e. Deactivate key lock.

Problem	Appliance will not be filled with water.
Cause	a. No water. b. Inlet hose is kinked. c. Inlet hose filter is blocked. d. Water pressure is less than 0.05MPa. e. Door is not properly closed. f. Water supply failure.
Solution	a. Check water tap. b. Check inlet hose. c. Unblock inlet hose filter. d. Check water pressure. e. Close the door properly. f. Ensure the water supply.

Problem	Appliance is draining while being filled.
Cause	a. Height of drain hose is below 80 cm. b. Drain hose end could reach into water.
Solution	a. Make sure that drain hose is properly installed. b. Make sure the drain hose is not in water.

Problem	Operation stops before completing wash cycle.
Cause	a. Water or electric failure
Solution	a. Check power and water supply.

Problem	Drainage failure.
Cause	a. Drain hose is blocked. b. Pump filter is blocked. c. Drain hose end is higher than 100 cm above floor level.
Solution	a. Unblock drain hose. b. Clean pump filter. c. Make sure that drain hose is properly installed.

Problem	Strong vibration while spinning.
Cause	a. Not all transportation bolts have been removed. b. Appliance has no solid position. c. Machine load is not correct.
Solution	a. Remove all transportation bolts. b. Ensure solid ground and a levelled position. c. Check load weight and balance.

Problem	Operation stops for a period of time.
Cause	a. Appliance displays error code. b. Problem due to load pattern. c. Programme performs soaking cycle.
Solution	a. Consider display codes. b. Reduce or adjust load. c. Cancel programme and restart.

Problem	Excessive foam floats drum and/or detergent drawer.
Cause	a. Detergent is not appropriate. b. Excessive use of detergent.
Solution	a. Check detergent recommendations. b. Reduce amount of detergent.

11-Troubleshooting

Problem	Automatic adjustment of washing time.
Cause	a. Washing programme duration will be adjusted.
Solution	a. This is normal and doesn't affect functionality.

Problem	Spinning fails.
Cause	a. Unbalance of laundry.
Solution	a. Check machine load and laundry and run a spinning programme again.

Problem	Unsatisfactory washing result.
Cause	a. The degree soiling and stains is not appropriate to the chosen cycle. b. Detergent quantity was not sufficient. c. Maximum load has been exceeded. d. Laundry was unevenly distributed in the drum.
Solution	a. Select another programme. b. Choose the detergent according to the degree of soiling or stains using manufacturers specifications. c. Reduce loading. d. Loosen the laundry.

Problem	Washing powder residues are on the laundry.
Cause	a. Insoluble particles of detergent can remain as white spots on the laundry.
Solution	a. Perform extra rinse. b. Try to brush the points from the dry laundry. c. Choose another detergent.

Problem	Laundry has grey patches.
Cause	a. Caused by fats such as oils, creams or ointments.
Solution	a. Pretreat the laundry with a special cleaner.

Problem	Small amount of water in the drum at end of cycle
Cause	a. Drain hose is blocked. b. Environmental conditions may be affecting dryer operation.
Solution	a. Check whether the drain hose is blocked. b. Check the drain hose is still attached at the back of the machine, and is not kinked or squashed. c. If conditions are particularly hot, humid or cold, it is possible water may recondense in the drum or on the inside of the door.

Problem	Noises
Cause	a. Dryer is overloaded. b. Dryer makes unfamiliar noises.
Solution	a. Remove some items from the dryer. b. At the start of the cycle the dryer may make some unfamiliar noises when the compressor turns on. This is normal.

Problem	Vibration
Cause	a. Dryer is not installed on a stable surface. b. Dryer is not level. c. Dryer is overloaded.
Solution	a. Ensure the dryer is installed on a flat, stable surface. b. Ensure the dryer is correctly levelled. c. Remove some items from the dryer.

Problem	Creasing
Cause	a. Cycle selection not appropriate for the load. b. Dryer is overloaded. c. Dry Level selected too high for load type.
Solution	a. Choose appropriate cycle. b. Refer to "Dry Cycles". c. Remove some items from the dryer. Try selecting a lower Dry Level.

11-Troubleshooting

Problem	Fabric damage
Cause	<ul style="list-style-type: none"> a. Instructions on care label not followed. b. DRYNESS LEVEL selected not appropriate for the fabric type. c. Metal parts on the items or in the load. d. Items not separated or dried on an appropriate cycle for the fabric type. e. Used a TIME DRY cycle and did not monitor the dryness of clothes during the cycle.
Solution	<ul style="list-style-type: none"> a. Follow the instructions on the care label of the items. b. Ensure the DRYNESS LEVEL selected is appropriate for the fabric type. Refer to the items care label. c. Fasten zips and other clasps before placing items in the dryer. d. Dry similar items together. Ensure an appropriate cycle is selected. e. Ensure that clothes are checked for dryness during the cycle when using the timed programmes to avoid over drying.

Problem	Linting
Cause	<ul style="list-style-type: none"> a. Lint filter not cleaned or replaced. b. Loads not sorted correctly. c. Clothes over dried.
Solution	<ul style="list-style-type: none"> a. Ensure the lint filter is cleaned after every cycle and replaced correctly. Refer to "Clean the upper drum lint filter". b. Dry lint-giving items separately from lint receivers. Also, dry similar colours together, eg light coloured items with light coloured items, dark items with dark items. Refer to "Dryer Preparation". c. Over drying clothes in the dryer can cause them to attract lint. Use an auto sensing cycle or ensure you check your load if using the time dry cycles to

Problem	Dye transfer
Cause	<ul style="list-style-type: none"> a. White/light and coloured items not separated before drying b. Wet items left sitting in the dryer for long periods of time before drying.
Solution	<ul style="list-style-type: none"> a. Remember to separate white/light and coloured items before placing them in the dryer. b. Refer to "Dryer Preparation" for tips to prevent dye transfer.

Problem	Tangling
Cause	<ul style="list-style-type: none"> a. Loads not separated during loading. b. Items loaded into the dryer incorrectly. c. Load size too large. d. Sheets and duvet/duona covers due to their size, are prone to tangling.
Solution	<ul style="list-style-type: none"> a. Try separating out larger items from smaller items. b. Load items individually into the dryer. Do not place folded items in the dryer. c. Try drying smaller load sizes. Some cycles have a lower maximum load size. Refer to "Drying cycles". d. Dry sheets and duvet/duona covers separately from other laundry, apart from towels. Ensure duvet/duona covers are buttoned or fastened closed before drying. Try adding a knotted towel to sheets loads if you are experiencing a lot of tangling.



Note: Foam formation

If too much foam is seen during spin cycle, motor stops and drain pump will be activated for 90 seconds. If that elimination of foam fails up to three times, programme ends without spinning.

We recommend our Haier Customer Service and the use of original spare parts, and the minimum period during which the spare parts for the household washing machine is 10 years.

If you have a problem with your appliance, please first check section Troubleshooting. If you can not find a solution there, please contact:

- ▶ your local dealer.
- ▶ the Service & Support area at www.haier-europe.com where you can find telephone numbers and FAQs and where you can activate the service claim.

For specific product information, please login to the Haier official website and search the model you use, click the product to go to the detail page then click "documents" to find the user manual to download it. You can also find the product information in this page.

To contact our Service, ensure that you have the following data available.
The information can be found on the rating plate.

Model _____ Serial No. _____

Also check the Warranty Card supplied with the product in case of warranty.

For general business enquiries please find below our addresses in Europe:

European Haier addresses			
Country *	Postal address	Country *	Postal address
Italy	Haier Europe Trading SRL Via De Cristoforis, 12 21100 Varese ITALY	France	Haier France SAS 3-5 rue des Gravières 92200 Neuilly sur Seine FRANCE
Spain Portugal	Haier Iberia SL Pg. Garcia Faria, 49-51 08019 Barcelona SPAIN	Belgium-FR Belgium-NL Netherlands Luxembourg	Haier Benelux SA Anderlecht Route de Lennik 451 BELGIUM
Germany Austria	Haier Deutschland GmbH Hewlett-Packard-Str. 4 D-61352 Bad Homburg GERMANY	Poland Hungary Greece Romania Russia	Haier Poland Sp. z o.o. Al. Jerozolimskie 181B 02- 222 Warszawa POLAND
United Kingdom	Haier Appliances UK Co.Ltd. One Crown Square Church Street East Woking, Surrey, GU21 6HR UK	Czech Republic and Slovakia	Haier Europe ČR s.r.o. Sokolovská 651/136a, 186 00 Praha 8, Czech Republic

*For more information please refer to www.haier-europe.com.

Haier



0020511802E