



User manual
Heat-Pump-Dryer

HD90-A3Q979U1
HD90-A3Q979SU1

EN

Haier

Thank you for purchasing a Haier Product.

Please read this instruction carefully before using the appliance. The instruction contains important information which will guide you in order to have a safe and proper installation as well as daily use and maintenance.

Keep this manual in a convenient place so you can always refer to it for the safe and proper use of the appliance.

Safety notice



Warning! – Important safety information



General information and tips



Environmental information

Disposal



This marking on the product, accessories or literature indicates that the product and its electronic accessories (e.g. charger, (e.g. charger, headset, USB cable) should not be disposed of with other household waste at the end of their working life.

To prevent possible harm to the environment or human health from uncontrolled waste disposal, please separate these items from other types of waste and recycle them responsibly to promote the sustainable reuse of material resources.

Household users should contact either the retailer where they purchased this product, or their local government office, for details of where and how they can take these items for environmentally safe recycling. Business users should contact their supplier and check the terms and conditions of the purchase contract.

This product and its electronic accessories should not be mixed with other commercial wastes for disposal.



WARNING!

Risk of injury or suffocation!

To ensure safety when disposing of an old tumble dryer, disconnect the mains plug from the socket, cut the mains power cable and destroy this together with the plug. To prevent children shutting themselves in the machine, break the door hinges or the door lock.



WARNING!

The appliance must not be powered through an external switching device, such as a timer, or connected to a circuit that is regularly switched on and off by a utility.

1-Safety information.....	4
2-Installation pictures.....	7
3-Intended use.....	8
4-Product description.....	9
5-Control panel.....	10
6-Programs.....	14
7-Consumption.....	15
8-Suggestions and tips.....	16
9-Daily use.....	18
10-Care and cleaning.....	22
11-Troubleshooting.....	24
12-Installation.....	26
13-Technical data.....	29
14-Hon.....	32
15-Customer Service.....	33



WARNING!

Before first use

- ▶ Make sure there is no transportation damage.
- ▶ Remove all package and keep it out of children's reach.
- ▶ Always move the appliance with two people at least because it is heavy.

Daily use

- ▶ This appliance can be used by children aged from 8 years and above and persons with reduced physical, sensory or mental capabilities or lack of experience and knowledge if they have been given supervision or instruction concerning use of the appliance in a safe way and understand the hazards involved.
- ▶ Keep away children under 3 years of age from the appliance unless they are constantly supervised.
- ▶ Children shall not play with the appliance.
- ▶ Do make sure the room is dry and well ventilated. The ambient temperature should be between 5 °C and 35 °C.
- ▶ Do not cover any ventilation openings in the base by a carpet or similar object.
- ▶ Keep the area around the tumble dryer free of dust and lint.
- ▶ Do make sure that there is only laundry inside the appliance and no pets or children before you use it.
- ▶ Only touch the mains plug with dry hands and do not touch or use the appliance if you are barefoot or with wet hands or feet
- ▶ Do not dry unwashed items in the tumble dryer.
- ▶ Do make sure not to load more than nominal load.
- ▶ Remove all items such as lighters and matches from pockets.
- ▶ Fabric softeners, or similar products, should be used as specified by the fabric softener instructions
- ▶ Do not use or store any flammable sprays or flammable gas in close vicinity to the appliance.
- ▶ Do not place heavy objects or sources of heat or damp on top of the appliance.
- ▶ Hold the plug, not the cable, when unplugging the appliance.
- ▶ Do not touch the rear and the drum during operation, they are hot.

**WARNING!****Daily use**

- ▶ Do not use the appliance to dry following items
 - ▶ Items which are not washed.
 - ▶ Items which have been contaminated with inflammable substances such as cooking oil, acetone, alcohol, benzine, petrol, kerosene, spot removers, turpentine, waxes, wax removers or other chemicals. The fumes can cause a fire or explosion. Items that have been soiled with substances such as cooking oil, acetone, alcohol, petrol, kerosene, spot removers, turpentine, waxes and wax removers should be washed in hot water with an extra amount of detergent before being dried in the tumble dryer
 - ▶ Items which contain padding or fillings (e.g. pillows, jackets), as the filling can get out with the risk of causing ignition.
 - ▶ Items such as foam rubber (latex foam) shower caps, water-proof textiles, rubber backed articles and clothes or pillows pillows fitted with foam rubber pads should not be dried in the tumble dryer.
- ▶ Do not drink the condensed water.
- ▶ Do not use the appliance without the lint filter or condenser filter in place or with damaged filter.
- ▶ Notice that the last part of the drying cycle occurs without heat (cool down cycle) to ensure remaining garments are under a temperature which does not damage them.
- ▶ Do not leave the appliance unattended during run time for a long time. If a long absence is needed, the drying cycle have to be interrupted by switching off and unplugging the mains.
- ▶ Do not switch off the appliance until drying cycle is finished, Never stop a tumble dryer before the end of the drying cycle unless all items are quickly removed and spread out so that the heat is dissipated
- ▶ Switch off the appliance after each drying programme to save electricity and for safety.

Maintenance / cleaning

- ▶ Make sure children are supervised if they carry out cleaning and maintenance.
- ▶ Disconnect the appliance from the electrical supply before undertaking any routine maintenance.



WARNING!

Maintenance / cleaning

- ▶ Clean the lint filter and the condenser filter after each programme (see CARE AND CLEANING).
- ▶ Do not use water spray or steam to clean the appliance.
- ▶ Do not use industrial chemicals to clean the appliance.
- ▶ If the supply cord is damaged, it must be replaced by the manufacturer, its service agent or similarly qualified persons in order to avoid a hazard.
- ▶ Do not try to repair the appliance by yourself. If a repair is needed, please contact our customer service.

Installation

- ▶ Ensure put the machine in a place which allows opening the door fully. Do not install the tumble dryer behind a lockable door, a sliding door or a door with hinges on the opposite side of the tumble dryer door as this limits the full opening of the door.
- ▶ Install the appliance in a well-ventilated, dry place.
- ▶ Never install the appliance in a damp outdoor, or in an area which has the risk of water leakage such as under or near a sink unit. Once a water leakage happened, cut power supply and allow the machine to dry naturally.
- ▶ Install or use the appliance only in a place where the temperature is above 5 °C.
- ▶ Do not place the appliance directly on a carpet, or close to a wall or furniture.
- ▶ Do not expose the appliance to any frost, heat or direct sunlight or around any heat sources (e.g. stoves, heaters).
- ▶ Make sure that the electrical information on the rating plate aligns with the power supply. If it does not, contact an electrician.
- ▶ Do not use multi-plug adapters and extension cables.
- ▶ Make sure not to damage the electric cable and the plug. If it is damaged, have it replaced by an electrician.
- ▶ Use a separate earthed socket for the power supply which is easy access to after installation. The appliance must be earthed.
- ▶ Only for UK: The appliance's power cable is fitted with 3-cord (grounding) plug that fits a standard 3-cord (grounded) socket. Never cut off or dismount the third pin (grounding). After the appliance is installed, the plug should be accessible.

2-Installation pictures

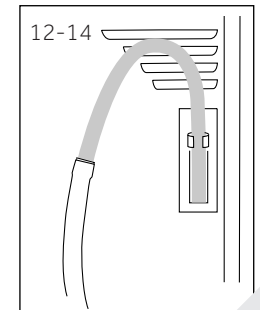
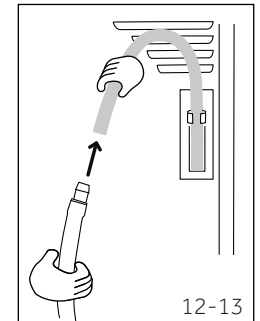
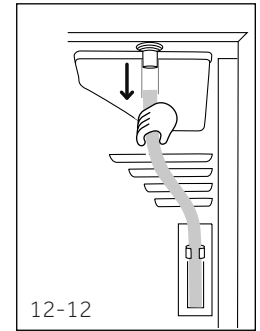
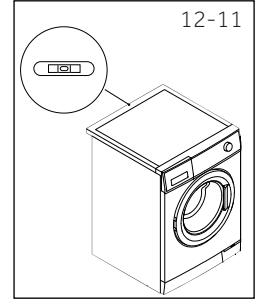
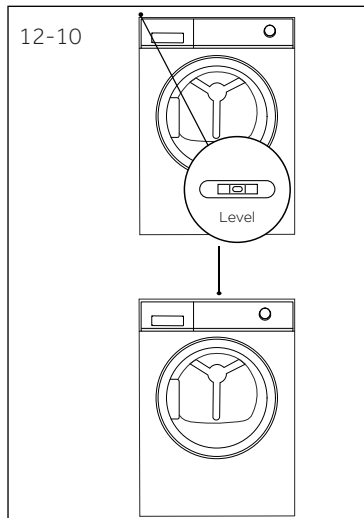
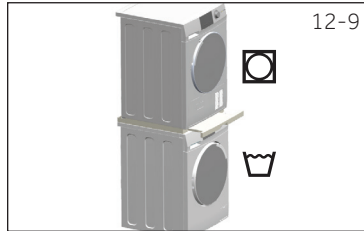
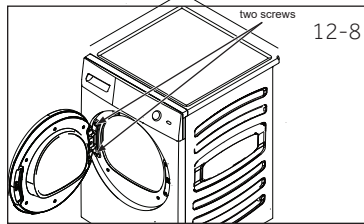
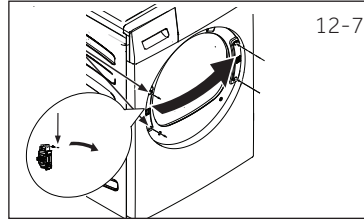
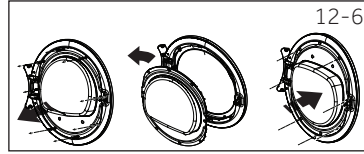
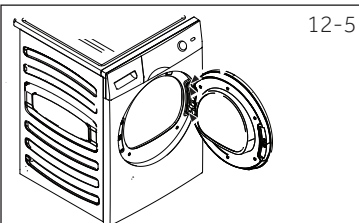
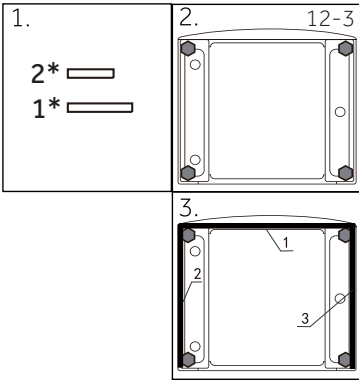
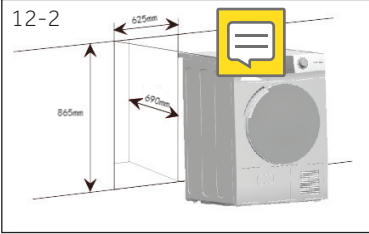

Intended use

This appliance is intended for drying items which have been washed in a water solution and are marked on the manufacturer's care label as being suitable for tumble drying.

It is designed exclusively for domestic use inside the house. It is not intended for commercial or industrial use. Changes or modifications to the device are not allowed. Unintended use may cause hazards and loss of all warranty and liability claims.

Standards and directives

This product meets the requirements of all applicable EC directives with the corresponding harmonised standards, which provide for CE marking.

Notice

The appliance contains the fluorinated greenhouse gas R134a (GWP:1430). This gas is hermetically sealed.

Environmentally responsible use

- ▶ **Completely spin:** Spin the laundry with the maximum spin speed.
- ▶ **Maximum load:** Use the maximum filling amount according to the programme table, but do not overload the dryer. To take advantage of the maximum load, the laundry which should be dried "READY to WEAR", can be first dried easily with "Ironing". When program ends, remove the laundry which should be ironed and dry the remaining laundry then to end.
- ▶ **Loosen up the laundry:** Shake out the laundry before putting them into the dryer.
- ▶ **Avoid excess drying:** An excessive drying should be avoided. Select the right programme and the appropriate dry level.
- ▶ **Softener unnecessary:** Do not use softener when washing, because the laundry will become fluffy and soft in the dryer .
- ▶ **Cleaning of the lint filters:** Clean the lint filters after each cycle.
- ▶ **Ventilation:** Make sure the appliance is properly ventilated (see INSTALLATION).
- ▶ **Condensed water reuse:** The collected condensed water can be used for the steam iron. Before that, it should be poured through a fine sieve or coffee filter paper, Smallest parts will be retained by the filter.

i Note:

Due to technical changes and different models, the illustrations in the following chapters may differ from your model.

4.1 Picture of appliance

Front (Fig. 4-1):



- 1 Water tank
- 2 Tumble dryer door
- 3 Control panel

Rear side (Fig. 4-2):

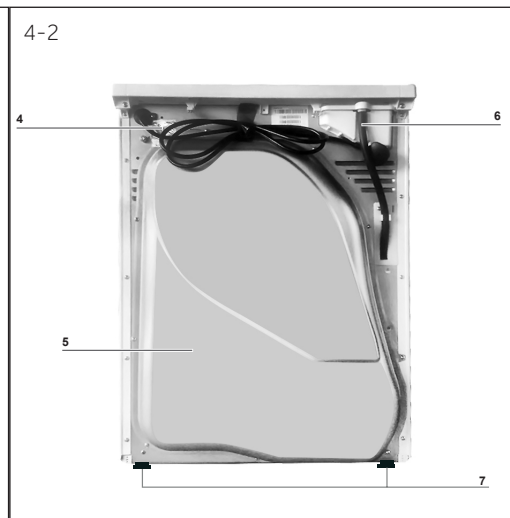

- 4 Power supply cord
- 5 Back plate
- 6 Drainage outlet
- 7 Adjustable feet

4.2 Accessories

Check the accessories and literature in accordance with this list (Fig.4-3):

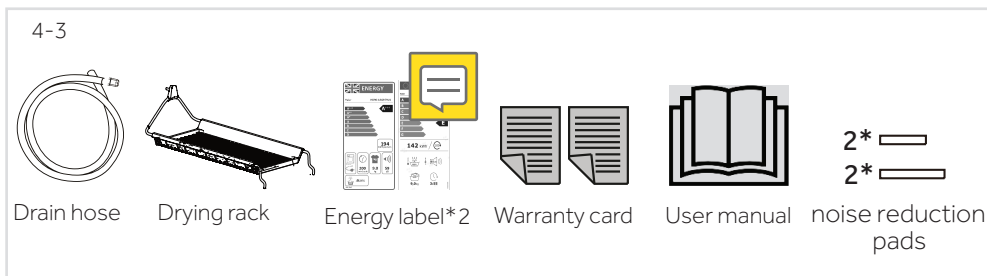

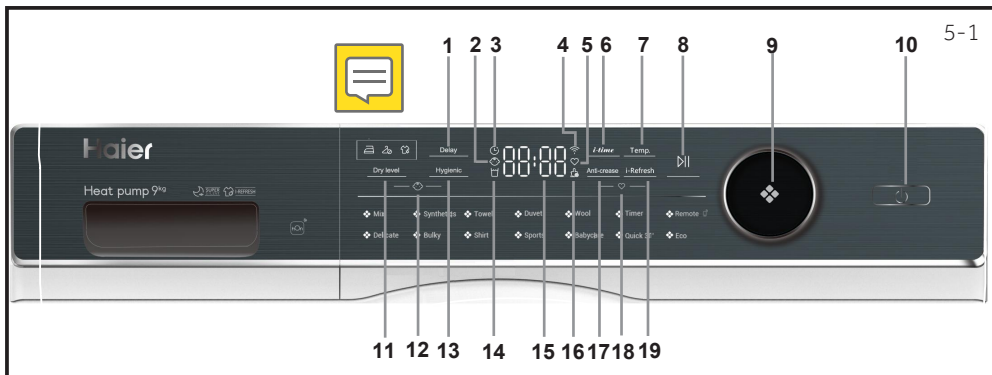

- | | | |
|------------------------|----------------------|---------------------------|
| 1 Delay button | 7 Temp. button | 13 Hygienic button |
| 2 Child-lock indicator | 8 Start/Pause button | 14 Empty tank indicator |
| 3 Delay indicator | 9 Program knob | 15 Display |
| 4 Wifi indicator | 10 Power button | 16 Clean filter indicator |
| 5 Favorite indicator | 11 Dry level button | 17 Anti-crease indicator |
| 6 i-time button | 12 Childlock button | 18 Favorite button |
| | | 19 i-Refresh button |

5.1 Delay button

Delay function allows users to delay the start time of the cycle (From 0 to 12 hours). When activated, icon (Fig. 5-2) will light up.



Notice

This function should be set after you finished all the options, otherwise when you turn the knob or press the button, the function will be cancelled automatically.

5.2 Child lock indicator

Child lock is designed to prevent children from adjusting the program setting. To activate this function, after a cycle has been started, touch to light up the screen, press the Dry Level and Hygienic button (Fig.5-3) at the same time for 3 seconds until the indicator icon lights up. To deactivate it, press these 2 buttons for 3 seconds again.

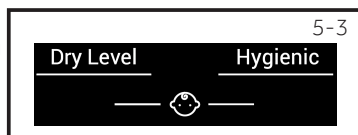

Notice

When the cycle ends or the power supply is interrupted, the function will not be cancelled automatically.

5.3 Delay indicator

When choosing the delay function (Fig. 5-4), the icon will light up.



5.4 Wifi indicator

This indicator reminds users whether the Wifi is connected or not (Fig. 5-5). If the wifi connection is successful, this indicator will light up.

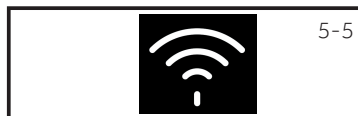

5-6



5.5 Favorite indicator

This indicator is designed to remind users whether the favorite function has been activated or not. If the icon lights up, the favorite function has been activated.

5-7



5.6 i-time button

This function is designed to allow users to adjust cycle duration based on personal needs. Only under Timer\ Wool\ Duvet programs, users can use this function to adjust time. Keep pressing this button (Fig.5-7) until showing the time you want to set.

5-8

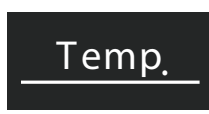

5.7 Temp. button

This button is set to adjust drying temperature based on personal needs or requirements. Pressing this button (Fig. 5-8) to set the drying temperature you want. There are 4 levels and matching display is shown below:

- [- -] High temperature.
- [-] Middle temperature.
- [-] Low temperature.
- [0 0] Cool air.

5-9



5.8 Start/Pause button

Press Start/Pause (Fig. 5-9) to Start a drying cycle. Press button again to pause the drying cycle. Press button again to continue.

5-10



5.9 Program knob

Select one of the 14 programs using the knob (Fig. 5-10). The indicator of the respective program lights up. See Program Modes section of the manual for further information.

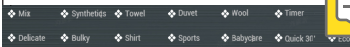

5-11



5.10 Power button

Press Power button (Fig. 5-11) to switch on/off the tumble dryer.

5.11 Dry Level button

Press the button (Fig. 5-12) to set the final moisture content of the laundry at the end of cycle. The display is shown below:



Cupboard



Ready to wear



Ready to iron

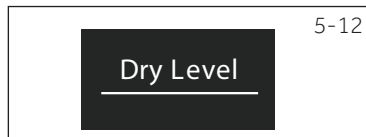

5.12 Childlock button activation

To activate the Child-lock function after a cycle has been started, touch to light up the screen, press the 2 buttons (Fig. 5-13) for 3 sec. until the indicator icon lights up. To deactivate press the 2 buttons for 3 sec. again.

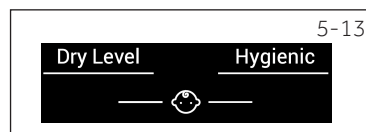

5.13 Hygienic Button

Hygienic function is designed to kill bacteria and mites as well as virus on clothes with high temperature.

The program setting will automatically change to the highest drying level and temperature. When the cycle ends, it will automatically continue drying for another 1.5 hours. For those programs that can add Hygienic function, when users turn the knob to those programs, the Hygienic button (Fig.5-14) will half light up to indicate that this function can be added. Only Mix/Cotton /Babycare /Towel / Bulky / Sports can add this function. When turning to other programs, Hygienic button will not light up meaning not selectable. After selecting Hygienic function, this button will keep light on until the drying cycle start. When entering to the hygienic phase, the button will light up again to indicate users.



5.14 Empty tank indicator

This indicator is designed to remind users the water tank should be emptied (Fig. 5-15). Important: Empty the water tank after each drying cycle. See Empty the water tank section of the manual.



5.15 Display

The display shows the remaining time, the delay time and other related information (Fig. 5-16).



Notice

The remaining time is a default value, this time will be re-calculated depending on additional program settings and the moisture content of the laundry.

5.16 Clean filter indicator

This indicator is designed to remind users to clean filter before using. When this icon (See fig. 5-17) lights up users should clean the filter before use. For the cleaning steps, see Lint filter cleaning or Condenser filter cleaning section of this manual.



Notice

After each cycle, indicator will twinkle to remind cleaning the filters.

5.17 Anti-crease indicator

Anti-crease function is designed to help remove wrinkles of clothes . The drum will rotate after the drying cycle to stretch clothes so there is no need to worry about forgetting to take out clothes. Anti-crease is deactivated by default (Fig.5-18). after selecting the program, the icon lights up, when the drying cycle ends, the drum will keep rotation for another 0-12 hours with cold wind in. Users can stop it anytime by opening the door or turning off the machine.



5.18 Favorite button

This function is designed to memory the users' preferred setting under each program so that there is no need to adjust it before use. To activate it, users can choose one program and adjust temperature, dry level based on their own taste and start the cycle. Touch to light up the screen, then push these 2 buttons together for 3 seconds to activate this function, the icon will light up. Next time, when users choose this program, it will automatically run the cycle under your preferred setting instead of default one. To revert to default setting, users can adjust back to default setting and favorite it or favorite another program.



Notice

1. Only under program operation status, users can activate this Favorite function.
2. Each time you can only Favorite one program.
3. Once this program being favorite, users cannot cancel it, it can only being replaced by another favorite program.

5.19 i-Refresh

I-Refresh is a Haier patent-owned function that aims to remove odors and wrinkles, eliminate bacteria and mites as well as refresh clothes in a short time. By rotating and shaking, wind blows in to fresh and stretch clothes, even delicate clothes and non-washable fabrics can be taken good care.



Programme	Default dry level	Laundry	Max. Load	Default Time	Temperature
 *)	Ready to wear	For cotton clothes or coats	9	2:30	60-65°C
Mix	Cupboard	For mixed dry with more than one fabrics	5	2:30	60-65°C
Synthetics	Ready to wear	For those synthetics	4	1:30	50-55°C
Quick 30'	/	A fixed 30 minutes dry	1	0:30	50-55°C
Timer	/	For mixed fabrics and users can decide drying time by themselves	-	0:40	50-55°C
Delicate	Ready to wear	For those delicate fabrics like silk, underwear etc.	1	1:00	50-55°C
Remote	/	/	-	-	-
Wool	/	For wool clothes	1	0:30	50-55°C
Towel	Cupboard	For heavy fabrics like towel etc.	5	1:40	50-55°C
Bulky	Cupboard	Heavy cotton	4	2:00	60-65°C
Sports	Ready to wear	For sports wear clothes	4	1:30	60-65°C
shirt	Ready to wear	Special for Shirts with 1 hour anti-crease default setting	2	0:40	50-55°C
Duvet	/	Feather clothes	2	1:30	60-65°C
Babycare	Cupboard	baby clothes	3	1:20	60-65°C

*) EN 61121 test program setting, we recommend that you drain the condensed water externally through the drain hose when drying a full load using the **Eco** program. This will avoid to empty the water tank during the cycle.



Heat pump technology

The condensation dryer with heat exchanger is outstanding in terms of efficient energy consumption. These are guide values determined under standard conditions. The values may differ from those given, depending on overvoltage and undervoltage, the type of fabric, composition of the laundry to be dried, the residual moisture and the actual loading.

loading. Taking HD90-A3Q2979U1 as a reference:

Program	Rated capacity (kg)	Time (h:min)	Residual moisture (%)	Energy consumption (kWh)
Ready to wear	9	3:16	2.0	1.61
Eco Ready to wear	4.5	1:59	2.0	0.86
synthetics Ready to iron	4	1:00	12.0	0.58
synthetics Ready to wear	4	1:30	2.0	0.80
synthetics Cupboard	4	1:50	0.0	1.10
Delicate Ready to wear	1	1:00	2.0	0.60



Environmentally responsible use

- ▶ Spin the laundry as dry as possible before putting it into the tumble dryer.
- ▶ Avoid overloading the tumble dryer.
- ▶ Shake the laundry loose before putting it into the tumble dryer.
- ▶ Choose a proper drying program. Make sure the laundry is not dried longer than needed.
- ▶ Make sure to use the tumble dryer with cleaned filters.

8.1 Starched laundry

Starched laundry leaves a film of starch in the drum and is not suitable for the dryer.

8.2 Softener

Do not use softener when washing, because the laundry will become soft and fluffy in the dryer.

8.3 Soft care cloths

The use of "soft care cloths" can lead to a coating at the lint filters. This can cause a blockage of the filters. In such cases, we recommend either to abstain from adding soft care cloths or to choose a different brand. In any case note the manufacturer's instructions.

8.4 Small amounts of filling

In a quantity of less than 1.0 kg, the "Timer"-programme should be selected because the dry level of clothes cannot be sensed sometimes due to the small load.

8.5 Open door

The door should be left ajar when not in use, so that the door seal can remain effective for a long time.

8.6 Drum interior light

When the appliance is switched on, the drum light will keep on when the door is open.

8.7 Service flap

Make sure that the service flap is always closed during operation.

8.8 Anti crease protection

At the end of the cycle, if the laundry is not taken out, the drum moves time to time to prevent creases.

8.9 Laundry which should be ironed

For those clothes that needs to be ironed, users should select dry level at "Ironing". Thus, it can help to iron quickly.

8.10 Remaining time

The program duration is influenced by the following factors: the type of fabric, the loading quantity, moisture content, the desired dry level, as well as the spin speed during washing. These factors are registered by the electronics during the program and the remaining time will be corrected accordingly.

8.11 Extra large pieces

When cycle ends, if the desired dry level is not achieved, loosen up the laundry and dry again with the time programme (TIMER).

8.12 Especially delicate fabrics

Textiles which can easily shrink or lose their shape, as well as silk stockings, lingerie should not be put in the dryer directly. Put delicate garments inside a laundry bag and avoid over drying them.

8.13 Jersey and knitwear

Clothes like jersey and knitwear, we recommend to use Delicate program to dry to avoid over-drying.

8.14 Acoustic signal

An acoustic signal can be activated:

- ▶ When the water tank is full.
- ▶ Failures happen.

Additionally the acoustic signal can also be selected for following cases:

- ▶ At the end of program.
- ▶ When pressing a button .
- ▶ When turning the program selector.

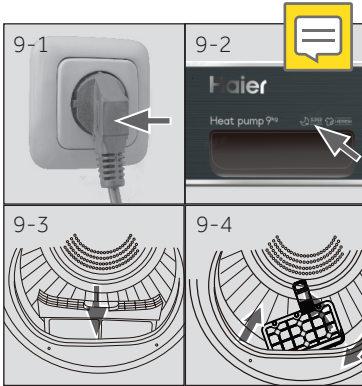

9.1 Prepare the appliance

1. Connect the appliance to a power supply (220V to 240V~/50Hz) (Fig. 9-1) Please also refer to section INSTALLATION.
2. Make sure:
 - ▶ The water tank is empty and properly installed. (Fig. 9-2).
 - ▶ The lint filter is clean and properly installed. (Fig. 9-3).
 - ▶ The condenser filter is clean and properly installed (Fig. 9-4).

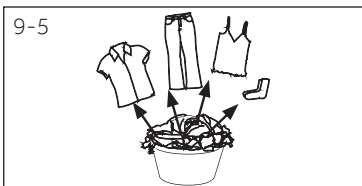

9.2 Prepare the laundry

- ▶ Sort clothes according to fabric (cotton, synthetics, wool etc.). Only dry clothes that has been spun.
- ▶ Empty pockets of all sharp or flammable objects such as keys, lighters and matches. Remove hard decorative objects such as brooches.
- ▶ Zippers up and make sure the buttons are sewn on tightly and place small items such as socks, bras etc. in a wash bag.
- ▶ Unfold bulky items of fabric such as bed sheets, table cloth etc.
- ▶ Follow the instructions on the laundry label and dry those garments that can be dried by machine.



Tips:

- ▶ Separate white clothes from coloured ones.
- ▶ Bed linen and pillowcases should be buttoned, so that small parts cannot stuck inside.
- ▶ Close zippers and hooks, and tie loose belts without metal parts, apron strings etc. together.
- ▶ Remove loose metal parts of clothes before putting into dryer such as metal buttons.
- ▶ Do not over-dry easy-care linen. Risk of creases. Allow final drying in open air.
- ▶ Clothes like knitwear can be over-drying sometimes. "Ironing" dry level are always recommended to choose
- ▶ For pre-dried, multi-layered garments or for final drying the time-programme (TIMER) should be chosen.

Load Reference	Composition	Average weight per item
Bed sheet (single)	Cotton	Approx. 800 g
Blended fabric clothes	/	Approx. 800 g
Jackets	Cotton	Approx. 800 g
Jeans	/	Approx. 800 g
Overalls	Cotton	Approx. 950 g
Pyjamas	/	Approx. 200 g
Shirts	/	Approx. 200 g
Socks	Blended fabrics	Approx. 50 g
T-Shirts	Cotton	Approx. 150 g
Underwear	Blended fabrics	Approx. 70 g

9.3 Load clothes the appliance

- ▶ Loosen up and insert presorted laundry.
- ▶ Don't overload.
- ▶ Close the door carefully. Make sure that clothes are not pinched.

9.4 Loading the dryer

1. Place the laundry evenly in the drum making sure not to overload the dryer.
2. Switch on the tumble dryer by pressing the Power button (Fig. 9-7).



Notice

Fabric softeners or similar products should be used as specified in the manufacturer's instructions.

9.5 Set program and start

1. Turn the program knob (Fig. 9-8) to select the desired program.
2. Set functions such as Temperature, Dry level, Delay. Afterwards press the Start/Pause button (Fig. 9-9) to start the dry cycle.

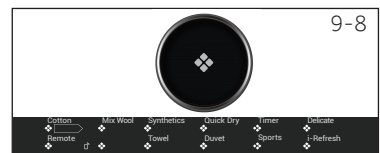

9.6 Take out and add clothes



To remove or add clothes, the program can be interrupted at any time:

- ▶ The cycle will be interrupted if opening the door.
Be careful when taking out or adding clothes! The Interior of the drum or the clothes itself may be hot, so that there is danger of burns .
- ▶ To continue the program, press the "Start/Pause" button after closing the door.



CAUTION!

Non-textile, as well as small, loose or sharp-edged items may cause malfunctions and damage of clothes and appliance.



WARNING!

Never turn the dryer off before the end of the drying cycle unless all items are quickly removed and spread out so that the heat can be released.

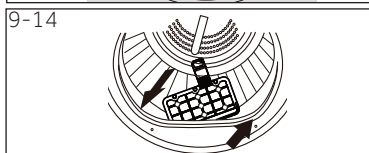
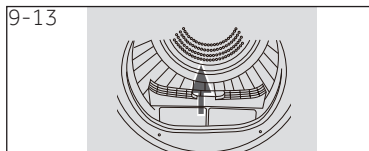

9.7 End of dry cycle

The tumble dryer stops operation automatically when a dry cycle is complete. The display shows END about 5S. Open the tumble dryer door and take out clothes . If clothes are not taken out, the wrinkle free function will start automatically and the screen shows 0:00 (This function is only available for some programs)

1. Switch off the tumble dryer by pressing the Power button (Fig. 9-10).
2. Unplug the tumble dryer from the power socket (Fig.9-11).
3. Empty the water tank after each dry cycle (Fig. 9-12) .
4. Clean the lint filter after each dry cycle (Fig.9-13).
5. Clean the condenser filter after each dry cycle (Fig.9-14).

9.8 Use dryer rack

The dryer rack is designed for items which are not recommended for tumble drying such as trainers, sneakers, sweaters or delicate lingerie.



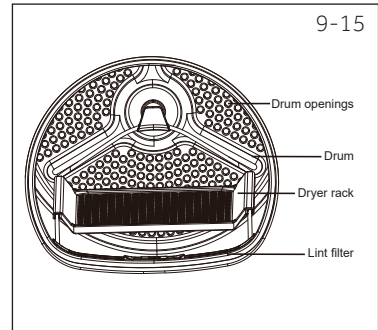



1. Open the dryer door.
2. Check that the drum is empty.
3. Put the dryer rack into the drum.
4. Make sure that the rack is inserted in the hole of the lint filter and locked in the hole of drum.



Notice

- ▶ Do not use this dryer rack when there are other clothes in the dryer.
- ▶ During drying, please make sure the items are placed on the rack with no risk of entangling the baffles while the drum is rotating.
- ▶ Maximum weight of wet items: 1.5 kg.

Care chart

Washing		
 Washable up to 95°C normal process	 Washable up to 60°C normal process	 Washable up to 60°C mild process
 Washable up to 40°C normal process	 Washable up to 40°C mild process	 Washable up to 40°C very mild process
 Washable up to 30°C normal process	 Washable up to 30°C mild process	 Washable up to 30°C very mild process
 Wash by hand max. 40°C	 Do not wash	
Bleaching		
 Any bleaching allowed	 Only oxygen/ non-chlorine	 Do not bleach
Drying		
 Tumble drying possible normal temperature	 Tumble drying possible lower temperature	 Do not tumble dry
 Line drying	 Flat drying	
Ironing		
 Iron at a maximum temperature up to 200 °C	 Iron at a medial temperature up to 150°C	 Iron at a low temperature up to 110 °C; without steam (steam ironing may cause irreversible damage)
 Do not iron		

10-1

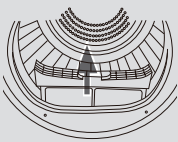

10.1 Lint filter cleaning

Clean the lint filter after each dry cycle.

1. Remove the lint filter from the drum (Fig. 10-1).

10-2

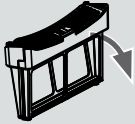

2. Open up the lint filter (Fig. 10-2).

10-3

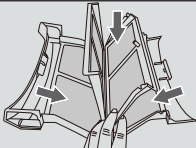

3. Remove the lint residuals from lint filter (Fig. 10-3).

10-4

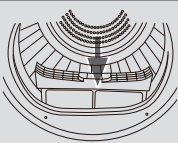

4. Reinstall the cleaned lint filter in the tumble dryer (Fig. 10-4).

10-5

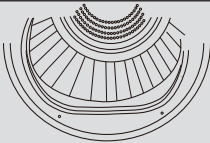

10.2 Condenser filter cleaning

Clean the filter after each dry cycle.

1. Open the door.

2. Pull out the lint filter from front duct (Fig. 10-6).

10-6

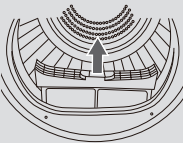

3. Pull out the condenser filter from the air duct (Fig. 10-7).

10-7

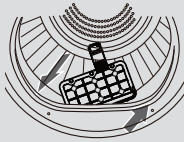

4. Separate the sponge and clean the filter the sponge and clean the filter screen form any residuals (Fig. 10-8).

10-8

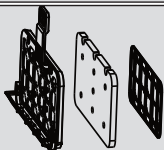

5. Reinstall the sponge to the condenser filter and put it back into the duct.



Notice

If the lint / the condenser filter is very dirty, it can be cleaned under running water. Let it dry completely before use.

i Notice

When cleaning the filters, the lint  should be thrown in the garbage bin and not washed through the drain in order to avoid spreading microplastics in the used water system. For optimal drying performance, clean the filter regularly. A clogged filter can lead to longer drying cycles, which can increase energy consumption.

10.3 Empty the water tank

During operation, steam is condensed into water and collected in the water tank. Empty the water tank after each drying cycle.

1. Pull out the water tank from its housing (Fig. 10-9).
2. Empty the water tank (Fig. 10-10).
3. Reinstall the water tank to the tumble dryer (Fig. 10-11).

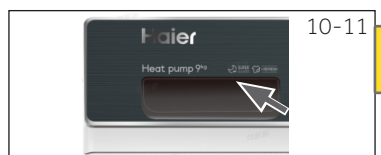

i Notice

Do not use the water for any kind of drinking or food processing.

10.4 Tumble dryer

Wipe the outside of the tumble dryer and the control panel with a damp cloth. Do not use any organic solvent or corrosive agent to avoid damage to the device.

10.5 Drum

After running for a while, micro elements like calcium and mineral substances contained in the water will result in an invisible film formed inside the drum. Use a damp cloth and some detergent to remove it. Do not use any organic solvent or corrosive agent to avoid damage to the device.

Many problems can be solved by yourself without specific expertise. please check all shown possibilities and follow below instructions before you contact an after sales service. See CUSTOMER SERVICE.



WARNING!

- ▶ Before maintenance, turn off the appliance and disconnect the mains plug from the socket.
- ▶ Electrical equipment should be serviced only by qualified electrical experts, because improper repairs can cause considerable consequential damages.
- ▶ A damaged power cable should only be replaced by the manufacturer, its service agent or similarly qualified workers in order to avoid a hazard.

Troubleshooting with display code

Code	Cause	Solution
F2	Drain pump error.	Contact the customer service.
F32 F33	The condenser thermal sensor is open-circuited or short-circuited.	Contact the customer service.
F4	Temperature of the laundry in the drum does not change.	Contact the customer service.
FL2	Communication failure between PCB and display.	Contact the customer service.
FL0	Main line malfunction	Contact the customer service.
FL1	Motor communication malfunction	Contact the customer service.
F7	Motor malfunction	Contact the customer service.

If the error codes appear again after taking measures, switch off the appliance, disconnect the power supply and contact the customer service.

Troubleshooting without display-codes

Problem	Possible cause	Possible solution
Tumble dryer fails to operate.	<ul style="list-style-type: none"> • Poor connection to the power supply. • Power failure. • No drying program is set. • Device has not been switched on. • The water tank is full. • The door is not closed properly. 	<ul style="list-style-type: none"> • Check connection to the power supply. • Check the power supply. • Set a drying program. • Switch on the device. • Empty the water tank. • Close the door properly.
Tumble dryer fails to operate and the display shows End .	<ul style="list-style-type: none"> • The laundry has reached the dry level defined by the programme. 	<ul style="list-style-type: none"> • Check the program setting is appropriate or not.
Drying time is too long and the results are not satisfactory	<ul style="list-style-type: none"> • The programme setting is not correct. • The filter is clogged. • The evaporator is blocked. • The tumble dryer is overloaded. • The laundry is too wet. • The vent duct is blocked. 	<ul style="list-style-type: none"> • Make sure the program is set correctly. • Clean the filter screen. • Clean the evaporator. • Reduce the amount of laundry. • Spin the laundry completely before drying. • Check and clean the vent duct.
Remaining time on the display-stops or skips.	<p>The remaining time will be adjusted continuously based upon the following factors:</p> <ul style="list-style-type: none"> • Fabric of laundry. • Loading weight. • Moisture degree of the laundry. • Ambient temperature. 	<p>The automatic adjustment is a normal operation.</p>

Notice: all installation relevant pictures can be found at the beginning of this manual.

12.1 Preparation

- ▶ Remove all packages including the polystyrene base firstly. While removing the package, water drops may be observed. This is normal phenomenon results from water test the factory.



Notice

Dispose of the package in an environmental friendly manner. For information referring to current disposal sites, consult your retailer or the local authorities.



WARNING!

After transportation and installation, you **MUST** leave the dryer to stand for two hours before use.

12.2 Transport and waiting time

Transport the appliance in horizontal position only. To the maintenance-free lubrication oil is located in the capsule of the compressor. This oil can get through the closed pipe system during slanting transport. Before connecting the appliance to the power supply you have to wait 2 hours so that the oil runs back into the capsule.

12.3 Place the appliance

The appliance should be placed on a flat and solid surface. Set the feet to the desired level(Fig. 12-1).

12.4 Installation under worktop

The dimensions of the recess should at least match with the dimensions(Fig. 12-2).

1. Put the appliance adjacent to the slot. Make sure that all connections are easily accessible and functional.
2. Adjust accurately all feet to get a firm level position.
3. Install the appliance prudently into the recess.
4. Make sure a sufficient ventilation.

OPTIONAL:Install noise reduction pads

1. When opening the shrink package,you will find three noise reduction pads. These are used for reducing noise(Fig. 12-3).
2. Lay the dryer machine down to its side, porthole pointing upwards,bottom side towards operator.
3. Take out the noise reduction pads and remove the double-sided adhesive protective film; paste around the bottom; the noise reduction pads under the dryer machine cabinet as shown in Figure 3(longer pad in position 1 , two shorter pads in position 2 and 3). Finally set the machine upright again.

12.5 Electrical connection

Before each connection check if:

- ▶ Power supply, socket and fusing are appropriate to the rating plate.
- ▶ The power socket is earthed and no multi-plug or extension.

- ▶ The power plug and socket are strictly match.
- ▶ **Only UK:** The UK plug meets BS1363A standard.

Put the plug into the socket(Fig. 12-4).



WARNING!

If the supply cord is damaged, it must be replaced by the service agent (see warranty card) in order to avoid a hazard!

12.6 Reversing the door (Only for 8/9kg models)

- ▶ Before you start, unplug the dryer from the socket.
- ▶ Handle parts carefully to avoid scratching paint.
- ▶ Provide a non-scratching work surface for the doors.
- ▶ Tools you will need: Phillips-head screwdriver.
- ▶ Once you begin, do not move the cabinet until door reversal is completed.
- ▶ These instructions are for changing the hinges from the right side to the left side. If you want to switch them back to the right side, follow these same instructions and reverse all references from left to right.

1. Remove the door assembly

Open the door. Remove the two screws holding the hinge/door assembly to the dryer. Carefully set the hinge/door assembly aside(Fig. 12-5).

2. Remove, rotate and replacethe inner door

Remove the eight stickers and screws securing the inner door to the outer door. Dismantle the inner door, rotate it 180° and reinstall it into the outer door using the same eight screws and stickers(Fig. 12-6).

3. Remove, rotate and replace the door lock & strike plate

Remove the two screws holding the strike plate, and then remove one screw of the door lock, push down and take out the lock, rotate 180° and install it on the opposite side using the same 3 screws and strikes(Fig. 12-7).

4. Rotate and replace the hinge/door assembly

Rotate the hinge/door assembly and screw it on the dryer(Fig. 12-8).

12.7 Wash-dryer stack

It is possible to achieve a washer-dryer stack. is possible (Fig. 12-9). Not every washing machine is suitable for this purpose. Stacking information, as well as the corresponding mounting kit are available via your local dealer.

The mounting instructions are supplied with the kit which thoroughly inform the installation steps.

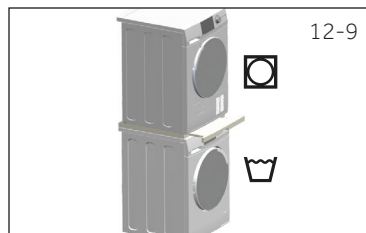

12.8 Level the dryer

It is **IMPORTANT** to level the dryer to ensure the machine runs efficiently with minimal noise. The dryer should be levelled in as close to its final position as possible so it stands balanced evenly on all four feet. Ensure the dryer does not rock in any direction.

Level the dryer side to side(Fig. 12-11):

- Place the gradienter at the centre back of the dryer.
- Adjust the rear feet until the dryer is level side to side.
- Never fully screw the feet completely from their housings.

Level the dryer front to back(Fig. 12-10):

- Place the gradienter on the left side.
- Adjust the front left foot (wind down).
- Repeat the above for the right foot.

Double check the dryer is balanced(Fig. 12-10):

- Place the gradienter at the centre front of the dryer.
- Ensure the dryer does not rock in any direction.
- If dryer is not balanced repeat the above steps.

After levelling, the corners of the dryer cabinet should be clear of the floor and the dryer must not rock in any direction.

12.9 Draining

The dryer is equipped with a condenser unit which accumulates water during the drying cycle. This water is collected in the removable water tank located at the top left of the dryer. The accumulated water must be emptied after each drying cycle or you can setup your dryer to drain automatically using the drain hose provided.

We recommend the dryer is set up to drain automatically where possible especially when drying full loads, this will avoid having to empty the water tank during a drying cycle.

Connecting the drain hose

- Remove the black hose from the connection at the back of the dryer(Fig. 12-12).
- Uncoil the drain hose (included with your dryer) and connect it to the black hose (Fig. 12-13).
- Place the other end of the drain hose into a tub or standpipe(Fig. 12-14).



Additional data

Power supply (refer to rating plate) - voltage / current / input	220–240 V-50 Hz/ 2.4 A/ 550 W
Permissible ambient temperature	5°C to 35°C
Fluorinated greenhouse gas	HFC-134a
Volume	0.24 kg
GWP	1430
Tonne(s) of CO ₂ equivalent	0.34

Product dimensions

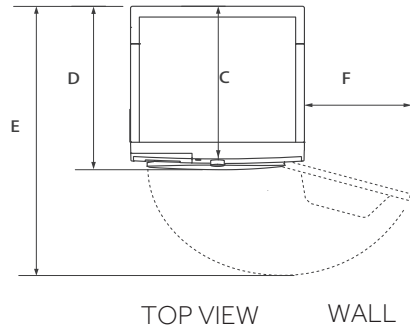
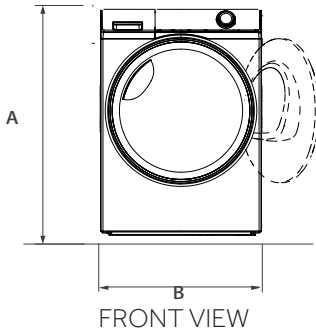

PRODUCT DIMENSIONS	HD90
A Overall height of product mm	845
B Overall width of product mm	595
C Overall depth of product (To main control board size) mm	600
D Overall depth of product mm	680
E Depth of door open mm	1135
F Minimum door clearance to adjacent wall mm	250

Note: The exact height of your dryer is dependent on how far the feet are extended from the base of the machine. The space where you install your dryer needs to be at least 40mm wider and 20mm deeper than its dimensions.

Note: Deviations

Due to constant updates of hOn, the functions and the display interface of the APP may differ from the following description.

14.1 General

This appliance is Wi-Fi enabled. With hOn App you can use your smartphone to control the program.



WARNING!

Please observe the safety precautions in this user manual and make sure that these are complied even when operating the appliance via the hOn APP while you are away from home. You must also follow the instructions in the hOn.

14.2 Requirements

1. One wireless router (802.11b/g/n protocol) which supports only the frequency band of 2.4 GHz. Length of Router SSID is 1-31 characters(including 1 and 31), and password is 8-64 characters. Minimum length of password must be 8 characters. Router encryption methods include open, WPA-PSK and WPA2-PSK.
2. The App is available for devices running Android, Huawei or iOS, both for tablets and for smartphones.
3. The appliance shall be installed in a position where it can receive a strong Wi-Fi signal. Once the appliance has been correctly associated with the APP, if it's not properly connected to the wireless router, no Wi-Fi icon appears on the display

14.3 Download and installation of hOn APP:

Download the hOn App on your device by framing the following QR code:



or by the link: go.haier-europe.com/download-app

Frequency rate(OFR)	2400 MHz - 2483.5 MHz
Max power(EIRP)	20dBm
Wireless standard	IEEE802.11b/g/n & BLE V4.2

Note: Registration

Registration is required when first time to use or the formal account has been deleted/closed. For further use, you need to enter user name and password when you log in.

14.4 Registration and App Pairing

1. Connect the smartphone to the home Wi-Fi network the same with the machine connect to.
2. Open the App.
3. Create the user profile (or log-in if it is already created previously).
4. Close the door.
5. Pairing the appliance following the instructions on the device display.



Note: Wi-Fi network

It is not possible to connect the appliance to a public Wi-Fi network. It may cause malfunction.



Note: Use same Wi-Fi

Make sure your smart phone and the machine connect to the same network.

14.5 Enable Remote Control

1. Check that the router is switched on and connected to the Internet.
2. Load the laundry and close the door.
3. Choose the Remote button.
4. Start the cycle via the APP and the control panel will be out of use.
5. Once the cycle finished, the remote control turns off.
6. After 2 minutes, the appliance will turn into off mode.



Note: Remote control expiration

Once the remote control is activated, if the end user doesn't start any cycle from app in 10 minutes, the appliance will go to Networked standby Mode, and keeps remote control up to 24 hours, then shut off.

14.6 Disable Remote Control

1. To exit remote control while a cycle is running, press START/PAUSE button on the control panel. The cycle will pause and Remote will blink.
2. To resume the cycle, close the door and press START/PAUSE button. The remote control will be reactivated and Remote will be fixed.
3. Control the appliance using the app.

14.7 End of Cycle With Remote Control On

1. At the end of the cycle, the remote control will deactivate.
2. After 2 minutes the appliance will automatically switch off.



Note: Network credentials cancellation/reset

Follow this procedure only if you are going to sell your dryer.

14.8 Network credential cancellation

1. Chose the Remote button.
2. "hOn" displayed.
3. Long press "Delay" button for 5 seconds till "PAt r" displayed.
4. Configuration information is deleted and reset configuration, then short press other programs or shut down to exit.

14.9 Use with voice assistants

This product can be operated through digital home voice assistants Alexa and Google Assistant and exact step by step procedure how to set up them is being described in APP.

15-Customer service

EN

We recommend our Haier Customer Service and the use of original spare parts.
If you have a problem with your appliance, please first check section TROUBLESHOOTING.

If you cannot find a solution there, please contact:

- ▶ Your local dealer or
- ▶ The Service & Support area at www.haier.com where you can find telephone numbers and FAQs and where you can activate the service claim.

To contact our Service, ensure that you have the following data available.
The information can be found on the rating plate.

Model _____ Serial No. _____

Also check the Warranty Card supplied with the product in case of warranty.

For general business enquiries please find below our addresses in Europe:

European Haier addresses			
Country*	Postal address	Country*	Postal address
Italy	Haier Europe Trading SRL Via De Cristoforis, 12 21100 Verese ITALY	France	Haier France SAS 53 Boulevard Ornano – Pleyad 3 93200 Saint Denis FRANCE
Spain Portugal	Haier Iberia SL Pg. Garcia Faria, 49-51 08019 Barcelona SPAIN	Belgium-FR Belgium-NL Netherlands Luxembourg	Haier Benelux SA Anderlecht Route de Lennik 451 BELGIUM
Germany Austria	Haier Deutschland GmbH Konrad-Zuse-Platz 6 81829 München GERMANY	Poland Hungary Greece Romania Russia	Haier Poland Sp. zo.o. Al. Jerozolimskie 181B 02-222 Warszawa POLAND
United Kingdom	Haier Appliances UK Co.Ltd. 302 Bridgewater Place Birchwood Park Warrington WA3 6XG	Czech Republic and Slovakia	Haier Europe ČR s.r.o. Sokolovská 651/136a, 186 00 Praha 8 Karlín Czech Republic



*For more information please refer to www.haier.com

HD90-A3Q979U1/HD90-A3Q979SU1

Haier