

Haier

HTF-540DGG7

HTF-540DP7

HTF-520WP7

HTF-520IP7

HCR5919FOPG



Refrigerator
User Guide

Kühlschrank
Bedienungsanleitung

Réfrigérateur
Mode d'emploi

Frigorifero
Guida per l'utente

Frigorífico
Manual del usuario

Frigorífico
Guia do Utilizador

Koelvriescombinatie
Handleiding

Lodówka
Podręcznik użytkownika

Congelator
Manual de utilizare

Chladnička
Uživatelská příručka

Hűtőszekrény
Felhasználói útmutató

ΨΥΓΕΙΟ
ΟΔΗΓΙΕΣ ΧΡΗΣΗΣ

EN

DE

FR

IT

ES

PT

NL

PL

RO

CZ

HU

EL



EN WARNING: Risk of fire/flammable material. The symbol indicates there is a risk of fire since flammable materials are used. Take care to avoid causing a fire by ingiting flammable material.

DE WARNUNG: Brandgefahr/ brennbare Material. Das Symbol weist auf Brandgefahr hin, da brennbare Materialien verwendet werden.

Verhindern Sie die Entstehung von Bränden, die durch entflammbare Materialien verursacht werden.

FR ATTENTION: Risque d'incendie ou de matières inflammables. Le symbole montre qu'il y'a le risque de matériaux inflammables sont utilisés. Prendre soin d'éviter de provoquer un incendie en ingérant des matières inflammables.

IT ATTENZIONE: Rischio di incendio/materiali infiammabili. Il simbolo indica il rischio di incendio nel caso di utilizzo di materiali infiammabili. Fare attenzione ed evitare l'insorgere di incendi a causa della combustione di materiali infiammabili.

ES ADVERTENCIA: Riesgo de incendio o material inflamable. El símbolo indica que existe riesgo de incendio, dado que se utilizan materiales inflamables. Se debe procurar evitar incendios mediante la combustión de materiales inflamables.

PT ADVERTÊNCIA: Risco de incêndio/material inflamável. O símbolo indica que existe um risco de incêndio uma vez que são usados materiais inflamáveis. Ter cuidado para evitar provocar um incêndio por acender material inflamável.

NL WAARSCHUWING: Brandrisico / brandbaar materiaal. Het systeem geeft aan dat er een brandrisico bestaat aangezien brandbaar materiaal wordt gebruikt. Zorg ervoor dat er geen brand wordt veroorzaakt door brandbaar materiaal te ontsteken.

PL OSTRZEŻENIE: Ryzyko pożaru/material łatwopalny. Symbol wskazuje, że istnieje ryzyko pożaru, ponieważ używane są materiały łatwopalne. Dbaj o to, aby uniknąć pożaru poprzez zapale nie łatwopalnego materiału.

RO AVERTISMENT: Risc de incendiu/material inflamabil. Simbolul indică că există risc de incendiu deoarece sunt folosite materiale inflamabile. Aveți grijă și evitați incendiile aprinzând materiale inflamabile

CZ VAROVÁNÍ: Nebezpečí Požáru/ Hořlavého Materiálu. Symbol označuje riziko požáru, protože byly použity hořlavé materiály. Dbejte na to, aby nedošlo ke vzniku požáru zapálením hořlavého materiálu.

HU FIGYELEM: Tűz / gyúlékony anyag veszélye. A szimbólum azt jelzi, hogy tűzveszély áll fenn, mivel gyúlékony anyagokat használnak. Ügyeljen arra, hogy ne tegyen rá tűzveszélyes gyúlékony anyagot.

EL ΠΡΟΣΟΧΗ: Κίνδυνος φωτιάς/εύφλεκτο υλικό. Το σύμβολο υποδεικνύει ότι υπάρχει κίνδυνος φωτιάς επειδή χρησιμοποιούνται εύφλεκτα υλικά. Προσέχετε να αποφεύγετε την πρόκληση φωτιάς από ανάφλεξη εύφλεκτου υλικού.



User Manual

Refrigerator-Freezer

HTF-540DGG7

HTF-540DP7

HTF-520WP7

HTF-520IP7

HCR5919FOPG

Haier

EN

Thank you for purchasing a Haier Product.

Please read these instructions carefully before using this appliance. The instructions contain important information which will help you get the best out of the appliance and ensure safe and proper installation, use and maintenance.

Keep this manual in a convenient place so you can always refer to it for the safe and proper use of the appliance.

If you sell the appliance, give it away, or leave it behind when you move house, make sure you also pass this manual so that the new owner can become familiar with the appliance and safety warnings.



Legend

Warning – Important Safety information



General information and tips



Environmental information



Disposal

Help protect the environment and human health. Put the packaging in applicable containers to recycle it. Help to recycle waste of electrical and electronic appliances. Do not dispose appliances marked with this symbol with the household waste. Return the product to your local recycling facility or contact your municipal office.



WARNING!

Risk of injury or suffocation!

Refrigerants and gases must be disposed of professionally. Ensure that the tubing of the refrigerant circuit is not damaged before being properly disposed of. Disconnect the appliance from the mains supply. Cut off the mains cable and dispose of it. Remove the trays and drawers as well as the door catch and seals, to prevent children and pets to get closed in the appliance.

Old appliances still have some residual value. An environmentally friendly method of disposal will ensure that valuable raw materials can be recovered and used again.

Cyclopentane, a flammable substance not harmful to ozone, is used as an expander for the insulation foam.











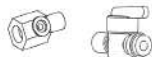

By ensuring this product is disposed of correctly, you will help prevent potential negative consequences for the environment and human health, which could otherwise be caused.

For more detailed information about recycling of this product, please contact your local council, your household waste disposal service or the shop where you purchased the product, handled by the professionals.

Safety information	4
Intended use.....	9
Product description.....	10
Control panel.....	11
Use.....	12
Equipment	22
Care and cleaning.....	25
Troubleshooting	27
Installation.....	30
Technical data	34
Customer service.....	36

Accessories

Check the accessories and literature in accordance with this list:

	HTF-540 DGG7	HTF-520 IP7	HTF-520 WP7	HTF-540 DP7 HCR5919 FOPG		HTF-540 DGG7	HTF-520 IP7	HTF-520 WP7	HTF-540 DP7 HCR5919 FOPG
 Water pipe*1		✓	✓		 Ice shovel*1		✓		
 Water filter*1		✓	✓		 Energy-label*1	✓	✓	✓	✓
 1/2" adapter with valve*1		✓	✓		 Warranty card*1 Extended warranty card*1	✓	✓	✓	✓
 clip*2		✓	✓		 User manual*1 *OK* Sticker User Manual*1	✓	✓	✓	✓
 spacer*3	✓	✓	✓	✓	 Ice cube tray*2	✓		✓	✓
 Egg tray*2	✓	✓	✓	✓	 3/4" adapter*1		✓	✓	



Notice

The list only show the key accessories. Other accessories in kind prevail.

Before switching on the appliance for the first time read the following safety hints!:



WARNING!

Before first use

- ▶ Make sure there is no transport damage.
- ▶ Remove all packaging and keep out of children's reach.
- ▶ Wait at least two hours before installing the appliance in order to ensure the refrigerant circuit is fully efficient.
- ▶ Handle the appliance always with at least two persons because it is heavy.

Installation

- ▶ The appliance should be placed in a well-ventilated place. Ensure a space of at least 10 cm above and around the appliance.
- ▶ Never place the appliance in a damp area or location where it might be splashed with water. Clean and dry water splashes and stains with a soft clean cloth.
- ▶ Do not install the appliance in direct sunlight or in the near of heat sources(e.g. stoves, heaters).
- ▶ Install and level the appliance in an area suitable for its size and use.
- ▶ Keep ventilation openings in the appliance or in the in-built structure clear of obstruction.
- ▶ Make sure that the electrical information on the rating plate agrees with the power supply. If it does not, contact an electrician.
- ▶ The appliance is operated by a 220-240 VAC/50 Hz power supply. Abnormal voltage fluctuation may cause the appliance to fail to start, or damage to the temperature control or compressor, or there may be an abnormal noise when operating. In such case, an automatic regulator shall be mounted.
- ▶ Do not use multi-plug adapters and extension cables.
- ▶ Do not locate multiple portable socket-outlets or portable power supplies at the rear of the appliance.
- ▶ Ensure that the power cable is not trapped by the refrigerator. Do not step on the power cable.

**WARNING!**

- ▶ Use a separate earthed socket for the power supply which is easily accessible. The appliance must be earthed.

Only for UK: The appliance's power cable is fitted with 3-cord (grounding) plug that fits a standard 3-cord (grounded) socket. Never cut off or dismount the third pin (grounding). After the appliance is installed, the plug should be accessible.

- ▶ Do not damage the refrigerant circuit.

Daily use

- ▶ This appliance can be used by children aged from 8 years and above and persons with reduced physical, sensory or mental capabilities or lack of experience and knowledge if they have been given supervision or instruction concerning use of the appliance in a safe way and understand the hazards involved.
- ▶ Children aged from 3 to 8 years are allowed to load and unload, but not allowed to clean or install the refrigerating appliances.
- ▶ Keep away children under 3 years of age from the appliance unless they are constantly supervised.
- ▶ Children shall not play with the appliance.
- ▶ If cool gas or other inflammable gas is leaking in the vicinity of the appliance, turn off the valve of the leaking gas, open the doors and windows and do not unplug a plug in the power cable of the refrigerator or any other appliance.
- ▶ Notice that the appliance is set for operation at a specific ambient range between 10 and 38°C. The appliance may not work properly if it is left for a long period at a temperature above or below the indicated range.
- ▶ Do not place unstable articles (heavy objects, containers filled with water) on top of the refrigerator, to avoid personal injury caused by falling or electric shock caused by contact with water.
- ▶ Do not pull on the door shelves. The door may be pulled slant, the bottle rack, may be pulled away, or the appliance may topple.
- ▶ Open and close the doors only with the handles. The gap between the doors and between the doors and the cabinet is very narrow. Do not extend your hands in these areas to avoid pinching your fingers. Open or close the refrigerator doors only when there are no children standing within the range of door movement.



WARNING!

- ▶ Do not store or use inflammable, explosive or corrosive materials in the appliance or in the vicinity.
- ▶ Do not store medicines, bacteria or chemical agents in the appliance. This appliance is a household appliance. It is not recommended to store materials that require strict temperatures.
- ▶ Never store liquids in bottles or cans (besides high percentage spirits) especially carbonated beverages in the freezer, as these will burst during freezing.
- ▶ Check the condition of food if a warming in the freezer has taken place.
- ▶ Do not set unnecessarily low temperature in the refrigerator compartment. Minus temperatures may occur at high settings. Attention: Bottles can burst
- ▶ Do not touch frozen goods with wet hands (wear gloves). Especially do not eat ice lollies immediately after removal from the freezer compartment. There is the risk to freeze or the formation of frost blisters. FIRST aid: keep immediately under running cold water. Do not pull away!
- ▶ Do not touch the inside surface of the freezer storage compartment when in operation, especially with wet hands, as your hands may freeze onto the surface.
- ▶ Unplug the appliance in the event of a power interruption or before cleaning. Allow at least 7 minutes before restarting the appliance, as frequent starting may damage the compressor.
- ▶ Do not use electrical devices inside the food storage compartments of the appliance, unless they are of the type recommended by the manufacturer.

Maintenance / cleaning

- ▶ Make sure children are supervised if they carry out cleaning and maintenance.
- ▶ Disconnect the appliance from the electrical supply before undertaking any routine maintenance. Allow at least 7 minutes before restarting the appliance, as frequent starting may damage the compressor.

**WARNING!**

- ▶ Hold the plug, not the cable, when unplugging the appliance.
- ▶ Do not clean the appliance with hard brushes, wire brushes, detergent powder, petrol, amyl acetate, acetone and similar organic solutions, acid or alkaline solutions. Please clean with special refrigerator detergent to avoid damage.
- ▶ Do not scrape off frost and ice with sharp objects. Do not use sprays, electric heaters like heater, hair dryer, steam cleaners or other sources of heat in order to avoid damage to the plastic parts.
- ▶ Do not use mechanical devices or other means to accelerate the defrosting process, other than those recommended by the manufacturer.
- ▶ If the supply cord is damaged, it must be replaced by the manufacturer, its service agent or similarly qualified persons in order to avoid a hazard.
- ▶ Do not try to repair, disassemble or modify the appliance by yourself. In case of repair please contact our customer service.
- ▶ Eliminate the dust on the back of the unit at least once in the year to avoid hazard by fire, as well as increased energy consumption.
- ▶ Do not spray or flush the appliance during cleaning.
- ▶ Do not use water spray or steam to clean the appliance.
- ▶ Do not clean the cold glass shelves with hot water. Sudden temperature change may cause the glass to break.

Refrigerant gas information



WARNING!

The appliance contains the flammable refrigerant ISOBUTANE (R600a). Make sure the refrigerant circuit is not damaged during transportation or installation. Leaking refrigerant may cause eye injuries or ignite. If a damage has occurred, keep away open fire sources, thoroughly ventilate the room, do **not** plug or unplug the power cords of the appliance or any other appliance. Inform the customer service.

In case of eyes get into contact with the refrigerant, rinse immediately it under running water and call immediately the eye specialist.

Intended use

This appliance is intended for cooling and freezing food. It has been designed exclusively for use in household and similar applications such as staff kitchen areas in shops, offices and other working environments; farm houses and by clients in hotels, motels and other residential type environments as well as in bed-and-breakfast and catering business. It is not intended for commercial or industrial use.

Changes or modifications to the device are not allowed. Unintended use may cause hazards and loss of warranty claims.

Standards and directives

This product meets the requirements of all applicable EC directives with the corresponding harmonised standards, which provide for CE marking.



CAUTION!

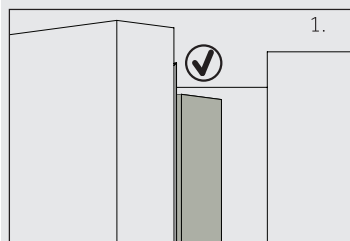

When you close the door, the vertical door strip on the left door should be bent inside (1).

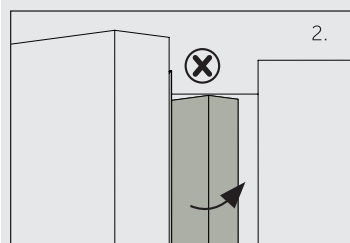

If you try to close the left door and the vertical door strip is unbent (2), you should bend it firstly, otherwise the door strip will hit the fixing shaft or right door. Thus a damage to the door slip or a leak will occur.

There is a heating thread inside the frame. The temperature of the surface will rise a little, which is normal and won't affect the function of appliance.



Notice

Due to technical changes and different models, some of the illustrations in this manual may differ from your model.

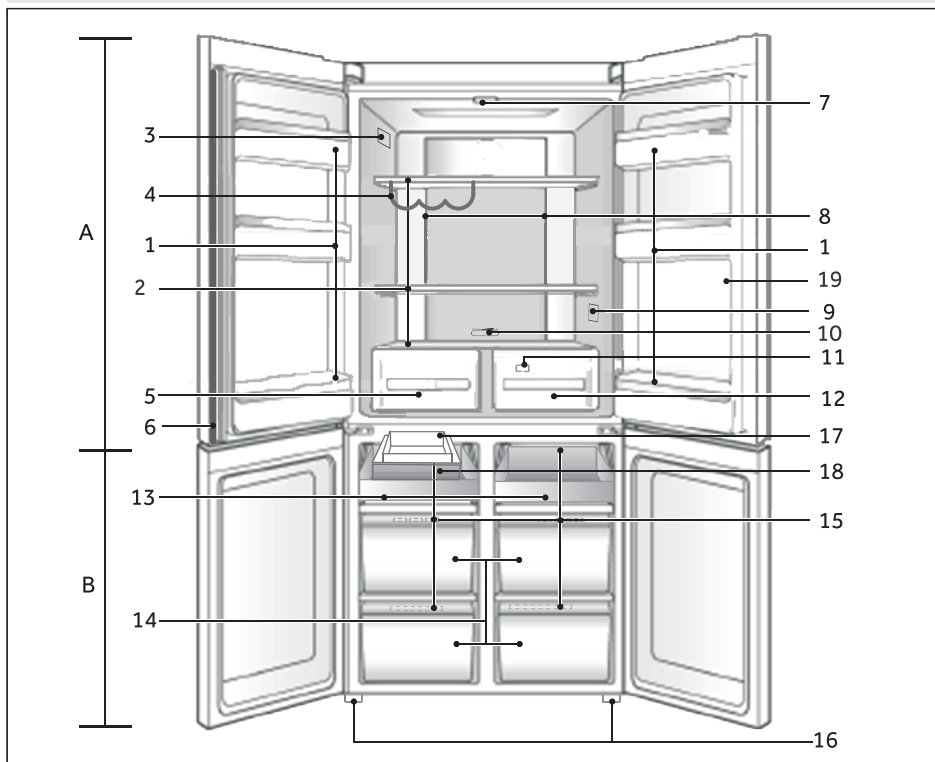

A: Refrigerator compartment

- 1 Bottle holder/Door rack
- 2 Glass shelves
- 3 Rating plate
- 4 Wine rack
- 5 Humidity box
- 6 Vertical beam
- 7 Ceiling lamp
- 8 Air duct and sensor (behind panel)
- 9 O.K.-temperature indicator (optional)
- 10 MyZone slider
- 11 Air duct (behind drawers)
- 12 MyZone box

B: Freezer compartment

- 13 Sliding shelf
- 14 Freeze box
- 15 Air duct
- 16 Adjustable feet
- 17 Auto ice maker (HTF-520IP7)
- 18 Ice tray (HTF-520IP7)
- 19 Water dispensing (HTF-520IP7/ HTF-520WP7)

Control panel

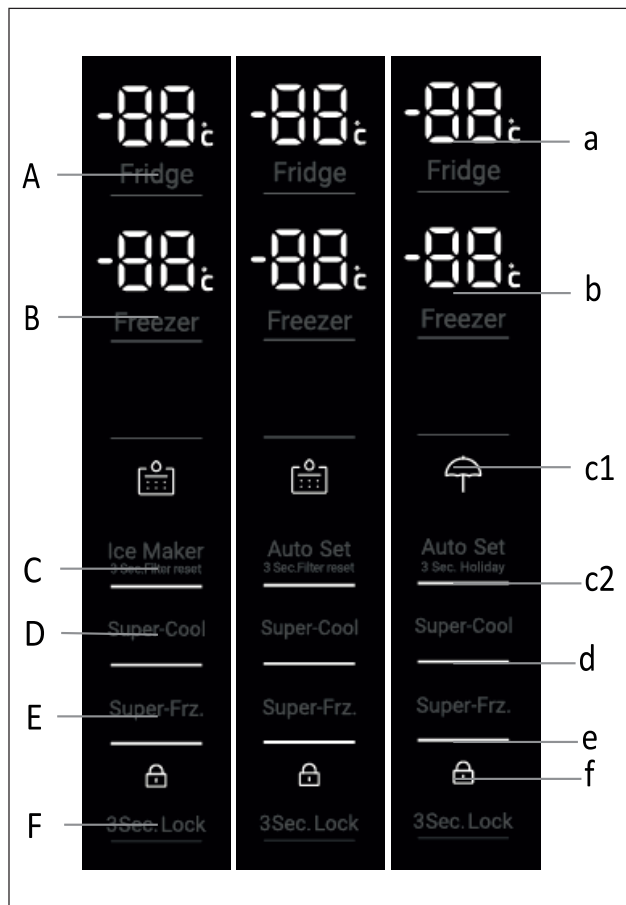

Buttons:

- A Fridge selector
- B Freezer selector
- C Auto Set mode and holiday function selector (HTF-540DGG7/ **HCR5919FOPG** HTF-540DP7)
- Auto Set mode and filter reset function selector (HTF-520WP7)
- Ice maker mode and filter reset function selector (HTF-520IP7)
- D Super-Cool selector
- E Super-Freeze selector
- F Panel lock selector

Indicators:

- a Temperature fridge
- b Temperature freezer
- c1 Holiday mode (HTF-540DGG7/ **HCR5919FOPG** HTF-540DP7)
- Water filter alarm (HTF-520IP7/ HTF-520WP7)
- c2 Auto Set mode
- d Super-Cool function
- e Super-Freeze function
- f Panel lock

Before first use

- ▶ Remove all packaging materials, keep them out of children`s reach and dispose them in an environmentally friendly manner.
- ▶ Clean the inside and outside of the appliance with water and a mild detergent before putting any food in it.
- ▶ After the appliance has been levelled and cleaned, wait for at least 2-5 hours before connecting it to the power supply. See Section INSTALLATION.
- ▶ Precool the compartments at high settings before loading with food. The function Power- Freeze helps to cool down the freezer compartment quickly.
- ▶ The refrigerator temperature and freezer temperature are automatically set to 4° C and -18° C respectively. These are the recommended settings. If desired, you can change these temperatures manually. Please see ADJUST THE TEMPERATURE.

Before first use the Ice and Water or Automatic Ice function

Before first use, you need to flush water through the filter to remove impurities or trapped air in the water tank and filter system.

For Ice and Water

- Press the water dispenser pad to dispense 4L of water – wait for 4 minutes before dispensing again.
- Dispense 4L of water and then wait for another 4 minutes – There may be carbon residue dispensed together with water. This is not harmful and normal during the flushing process.
- Dispense another 4 L of water. – This prevents excessive dripping of water from your dispenser.
- There may be a few drips of water coming out of the dispenser for a few days after installation. This is to clear the remaining trapped air in the dispenser.
- Ensure your refrigerator has cooled for at least 2 hours before use.

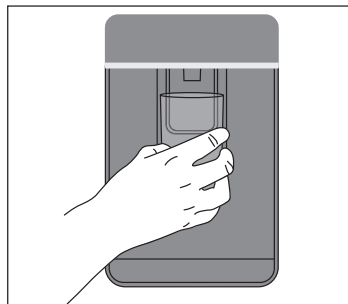

For Automatic Ice model

- 1 Press control panel button "C" to turn on the ice maker function.
- 2 Discard the first full bin of ice made. Clean the ice box with water and install it back. Your ice maker is now ready for use.
- 3 Repeat step 2 to remove dust in the ice tray collected during manufacture and transport.
- 4 Empty the water, dry the bin and return it correctly.
- 5 Once your Ice maker is turned on the first bin of ice may be discoloured. This is not harmful and normal during the flushing process. Discard the first full bin of ice made. Your Ice maker is now ready for use.



Notice

The performance of your water filter will increase with use, reaching optimum performance after two to three full bins of ice.

Sensor keys

The buttons on the control panel are sensor keys, which already respond when lightly touched with the finger.

Switch on /off the appliance

The appliance is in operation as soon as it is connected to the power supply.

When the appliance is powered on for the first time, the actual refrigerator and freezer temperatures are displayed. The display will flash. If the doors are closed it will switch off after 30 seconds.

Maybe the panel lock is active.



Notice

- ▶ The appliance is preset to the recommended temperature of 5°C (refrigerator) and - 18°C (freezer). Under normal ambient condition you need not to set a temperature.
- ▶ When the appliance is switched on after disconnection from the main power supply, it may take up to 12 hours for the correct temperatures to be reached.

Empty the appliance before switching off. To switch off the appliance, pull the power cord out of the power socket.

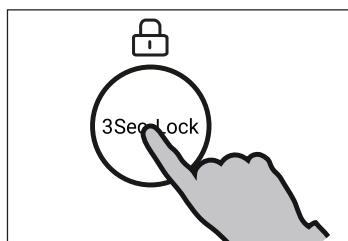

Lock/unlock panel



Notice

The control panel is automatically blocked against activation if the doors are closed and 30 seconds no button is pressed. For any settings the control panel must be unlocked.

- ▶ Touch button "F" for 3 seconds to block all panel elements against activation. The buzzer alarms and the related indicator "f" is now displayed; the lighting of the panel is switched off. The icon flashes if a button will be pressed, when the panel lock is activated. The change is not running.
- ▶ For unlocking press again the button.

Standby-mode

The display screen turns off automatically 30 seconds after pressing a key. The display will be automatically locked. It lights up automatically when pressing any key or opening any door (Alarm does not light up the display screen).

Select the working mode

You may need to select one of the following two ways to set the appliance:

1) Auto Set mode

Under Auto Set mode, the appliance can automatically adjust the temperature setting according to the ambient temperature and temperature change in the appliance. If you do not have any special requirements, we recommend that you use Auto Set mode (refer to Auto Set mode later on).

2) Manual adjusting mode:

If you want to manually adjust the temperature of the appliance in order to store a particular food, you can set the temperature via a temperature adjusting button (refer to ADJUST THE TEMPERATURE).

Door opening alarm

When the refrigerator door is opened for more than 1 minute, the door opening alarm will sound. The alarm can be silenced by either closing the door or touching the control panel. If the door is left open for more than 7 minutes, the light inside the compartment and control panel illumination will automatically switch off.



Adjust the temperature

The indoor temperatures are influenced by the following factors:

- ▶ Ambient temperature
- ▶ Frequency of door opening
- ▶ Amount of stored foods
- ▶ Installation of the appliance

Adjust the temperature for fridge

1. Unlock the panel by pressing button "F" if it is locked.
2. Press button "A" (Fridge) for select the fridge compartment. An alarm sounds. The actual temperature in the refrigerator compartment is displayed.
3. Press button "A" to set the fridge temperature. A signal will sound at each key press. The temperature decreases in sequences of 1°C from a maximum of 9°C to a minimum of 1°C, switching to 9°C again when pressing further. The optimum temperature in the refrigerator is 4 °C. Colder temperatures mean unnecessary energy consumption.

If no key is operated in 5 sec., the setting confirms automatically.

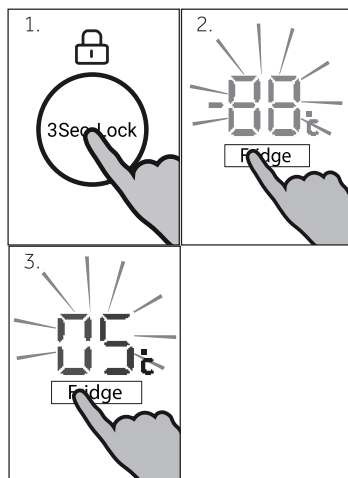

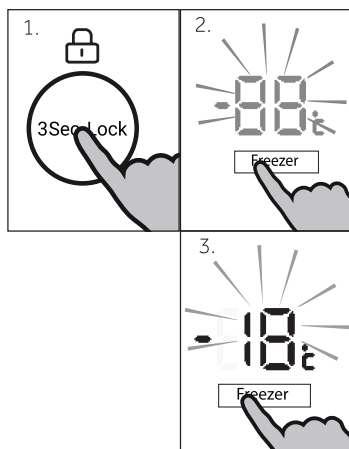

Adjust the temperature for freezer

- Unlock the panel by pressing button "F" if it is locked.
- Press button "B" (Freezer) for select the freezer compartment. An alarm sounds. The actual temperature in the freezer compartment is displayed.
- Press button "B" (Freezer) to set the freezer temperature. A signal will sound at each key press. The temperature decreases in sequences of 1°C from a maximum of -14°C to a minimum of -24°C, switching to -14°C again when pressing further. The optimum temperature in the freezer is -18°C. Colder temperatures mean unnecessary energy consumption.

If no key is operated in 5 sec., the setting confirms automatically.



Notice

The temperature in the corresponding compartment cannot be adjusted if any other function (Power-Freeze, Super-Cool, Holiday or Auto Set mode) is activated or the display is locked. The corresponding indicator will flash accompanying with a buzzer.

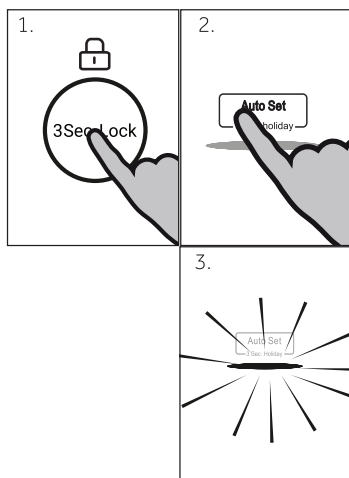

Auto Set mode

In the Auto Set mode, the appliance can automatically adjust the temperature setting according to the ambient temperature and temperature change in the appliance. This function is totally hand free.

- Unlock the panel by pressing button "F" if it is locked.
- Press button "C" (Auto Set). An alarm sounds.
- Indicator "c2" illuminates and the function is activated.

By repeating the above steps or selecting an other function this function can be switched off again.

Ice Maker mode

Under the Ice Maker mode, the refrigerator starts the automatic ice making function. When the ice box is full of ice, the process of ice making will stop.

1. Ensure the current situation is unlocked.
2. Press "C" (Ice Maker) and the buzzer make sound.
3. The indicator "c2" will lights up and starts the automatic ice making function.

In order to turn off the ice making function, also press "C" (Ice Maker) under the unlocked situation. The Ice Maker mode and the Super-Cool/Super-Freeze mode can be turned on at the same time.

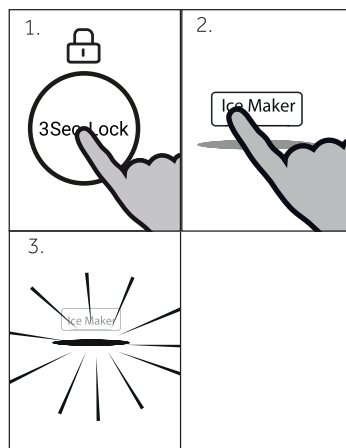

Holiday function

This function sets the refrigerator temperature permanently to 17°C.

This allows to keep the door of the empty refrigerator closed without causing an odour or mold - during a long absence (e.g. during holiday). The freezer compartment is free for your setting.

1. Unlock the panel by pressing button "F" if it is locked.
2. Press button "C" (Auto Set) for 3 seconds.
3. Indicator "c1" illuminates and the function is activated.

By repeating the above steps or selecting an other function this function can be switched off again.

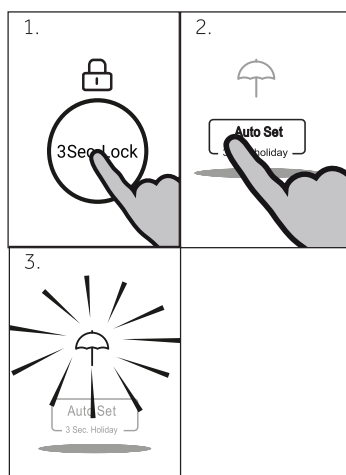

WARNING!

During the holiday function no goods must be stored in the refrigerator compartment. The temperature of + 17 °C is too high for storing food.

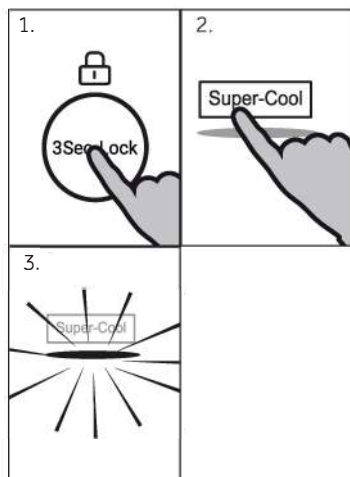

Super-Cool function

Switch on the Super-Cool function if larger quantity of food should be stored (for example after the purchase). The Power-Cool function accelerates the cooling of fresh food and protects the goods already stored from undesirable warming. The factory setting temperature is 0 to +1°C.

1. Unlock the panel by pressing button "F" if it is locked.
2. Press button "D" (Super-Cool).
3. Indicator "d" illuminates and the function is activated.

By repeating the above steps or selecting an other function this function can be switched off again.



Notice: Automatically switch off

This function will be automatically disabled after 6 hours

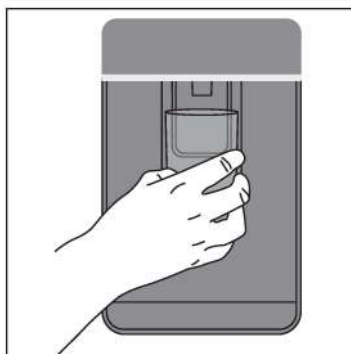

Using water dispenser (Water dispensing models only)

Ensure you have followed the steps outlined in "Before you start using the Ice and Water or Automatic Ice function" prior to your first use of water dispenser.

Dispensing

Your water dispenser is designed for one-handed operation. To dispense water, gently press the dispensing pad with a glass or container. To stop the flow of water, simply pull your glass or container away from the dispenser pad. Pressing hard against the dispensing pad will not increase the flow or dispense more water.



WARNING!

To avoid damage to property or personal injury do not put hands, fingers or objects up the dispenser opening.

Using ice maker (Ice and Water and Automatic Ice models only)

Ice On/Off

Your ice maker is designed to automatically dispense ice into the ice storage bin below until it detects the bin is full. The more ice you use, the more it makes.

First Use

The ice maker will be off when you turn your refrigerator on for the first time after installation. The light above the "Ice On/Off" icon will be off.