



HOOVER

Cooker hood Instruction Manual

CONTENT

1.....Notice

2.....Feature

3.....Installation

4.....Notice of installation

5.....Safety Warning

6.....Use

7.....Maintenance

8.....Troubleshooting

9.....Service Centre

(1) NOTICE

1. Thank you for choosing our cooker hood. Please read the instruction manual carefully before use.
2. The installation work must be undertaken by a qualified and competent fitter.
3. The manufacturer disclaims all liability for any damage or injury caused as a result of not following instructions for installation contained in the following text.
4. By placing the  marking on this product, we declare, on our own responsibility, compliance to all of European safety, health and environmental requirements stated in the legislation for this product.

The cooker hood is used on 220/240v, 50Hz.

(2) FEATURE

1. The cooker hood uses high quality materials, and is made with a streamlined design.
2. Equipped with a large power low noise electric motor and centrifugal leaf, it produces strong suction, low noise, non stick grease filter and easy to clean.
3. Special wind tunnel construction and oil collector design, free dirt will be absorbed in a second.

(3) INSTALLATION

3.1 The cooker hoods should be placed at a distance of 65-75cm from the cooking surface for best effect. See pic1.

3.2 To install onto the wall every 100mm drill 3 holes of Ø8mm on a suitable place in line with the hook on the hood.

3.3 Insert expended screws into the holes.

3.4 Fix the hook on the wall, put Drilling template on the hook. See pic2.

3.5 Add the soot tube to the one way valve, and put it outdoor. See pic3.

3.6 Calculate the final height of the U-shaped section, pull out the inside U-shaped section to a suitable height. (See pic4). Finally, drill 2 holes of Ø8mm on a suitable place in line with the 2nd plate. Repeat 3.3. Put the inside U-shaped on the 2nd plate and tighten the two screws (see

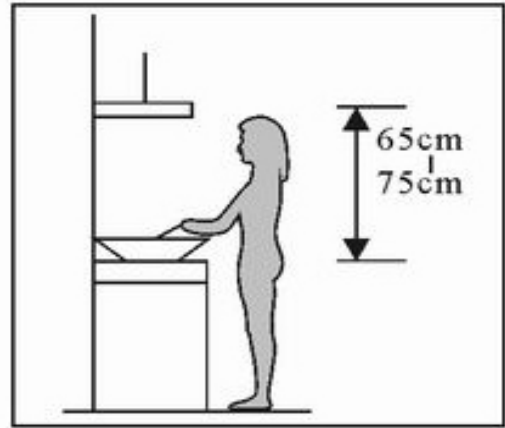

Pic1

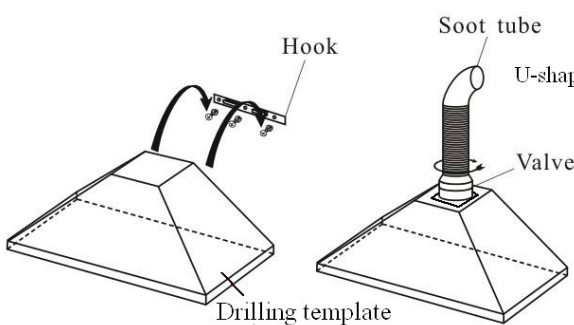

Pic2

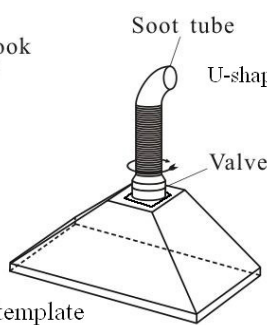

Pic3

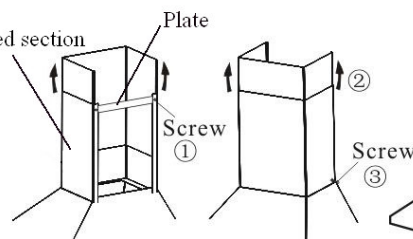

Pic4

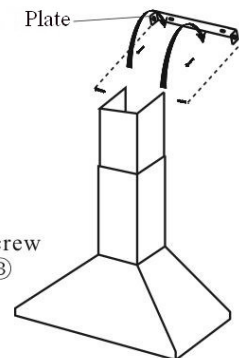

Pic4A

pic
4A)

(4) NOTICE OF INSTALLATION

1. Before installation, please ensure the area is clean to avoid suction of the remaining bits of broken wood and dust.
2. It cannot share the same air ventilation tube with other appliance such as gas tube, warmer tube, and hot wind tube.
3. The bending of ventilation tube should be $\geq 120^\circ$, parallel or above the start point and should be connected to the external wall.
4. After installation, make sure that the extractor is level to avoid grease collection at one end.

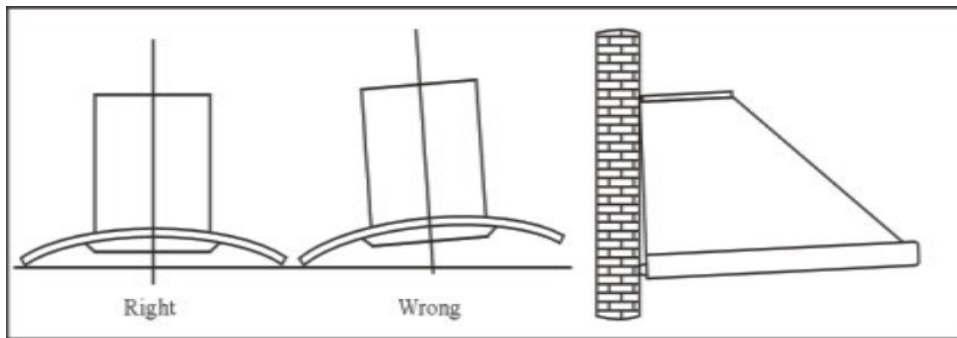

Pic5

(5) SAFETY WARNING

- Never let the children operate the machine
- The cooker hood is for home use only, not suitable for barbecue, Roast shop and other commercial purpose.
- Please ask the technical person to do the assembling.
- The cooker hood and its filter mesh should be clean regularly in order to keep in good working order.
- Before cleaning, please switch the power off at the main supply.
- Clean the cooker hood according to the instruction manual and keep the cooker hood from the danger of burning.
- If there is any fault with the appliance, please call the service department to arrange a service engineer.

(6) USE – (Speed adjustment. See pictures)

Push button

1. Push stop button, and the motor will stop.
2. Push the Low button, the buzzer will buzz once, and the motor runs at low speed.
3. Push the Mid button, the buzzer will buzz once, and the motor runs at mid speed.
4. Push the High button, the buzzer will buzz once, and the motor runs at high speed.
5. Push the light button and the two lights will come on. Push it again and the light will turn off.

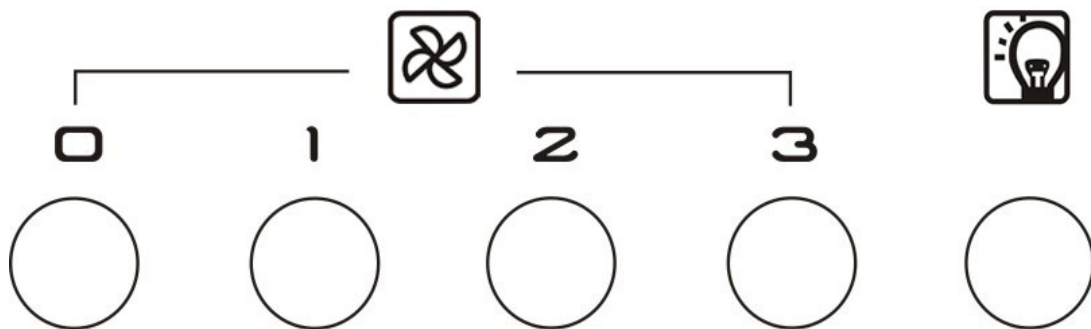

(7) MAINTENANCE

7.1 The cleaning of the carbon grease filter mesh

The filter mesh is made of high-density stainless steel. Please do not use the corrosive detergent on it. Keeping this filter clean will keep the appliance running correctly. Please strictly follow the guidelines below.
Method 1: Put the mesh into 40-50 c clean water, pour on detergent, and soak for 2-3 mins. Wear gloves and clean with a soft brush. Please do not apply too much pressure, as the mesh is delicate and will damage easy.

Method 2: If instructed to do so, it can be put into a dishwasher, set the temperature at around 60 degrees.

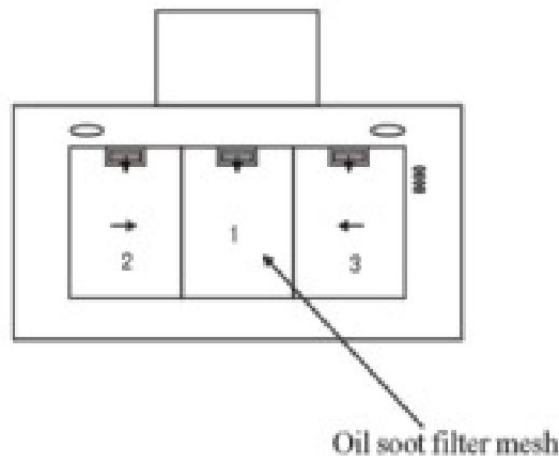

7.2 Notice of cleaning cooker hood

- A.** To protect the main body from corrosion over a long period of time, the cooker hood should be cleaned with hot water plus non corrosive detergent every two months.
- B.** Please do not use abrasive detergent for it will damage the body.
- C.** Keep the motor and other spare parts free from water, as this will cause damage to the appliance.
- D.** Before cleaning the appliance please remember to cut off power
- E.** The carbon filter shouldn't be exposed to heat.
- F.** Please don't tear open the fixed bar around the carbon filter
- G.** If the plug or cord is damaged, please replace it with special soft cord.

(8) TROUBLESHOOTING

| Fault | Cause | Solution |
|--|---|--|
| Light on, but motor does not work | The leaf blocked | Get rid of the blocking |
| | The capacitor damaged | Replace capacitor |
| | The motor jammed bearing damaged | Replace motor |
| | The internal with of motor off or a bad smell from the motor | Replace motor |
| Light does not work, motor does not work | Beside the above mentioned, check the following: | |
| | Light damaged | Replace lights |
| | Power cord looses | Connect the wires as per the electric diagram |
| Oil leakage | One way valve and the air ventilation entrance are not tightly sealed | Take down the one way valve and seal with glue |
| | Leakage from the connection of U-shaped section and cover | Take U-shaped section down and seal with soap or paint |
| Shake of the body | The leaf damaged and causes shaking | Replace the leaf |
| | The motor is not tightly hanged | Lock the motor tightly |
| | The body is not tightly hanged | Fixed the body tightly |
| Insufficient suction | The distance between the body and the gas top too long | Readjust the distance |
| | Too much ventilation from open doors or windows | Choose a new place and resemble the machine |
| The machine inclines | The fixing screw not tight enough | Tighten the hanging screw and make it horizontal |
| | The hanging screw not tight enough | Tighten the hanging screw and make it horizontal |

Electrical Diagram

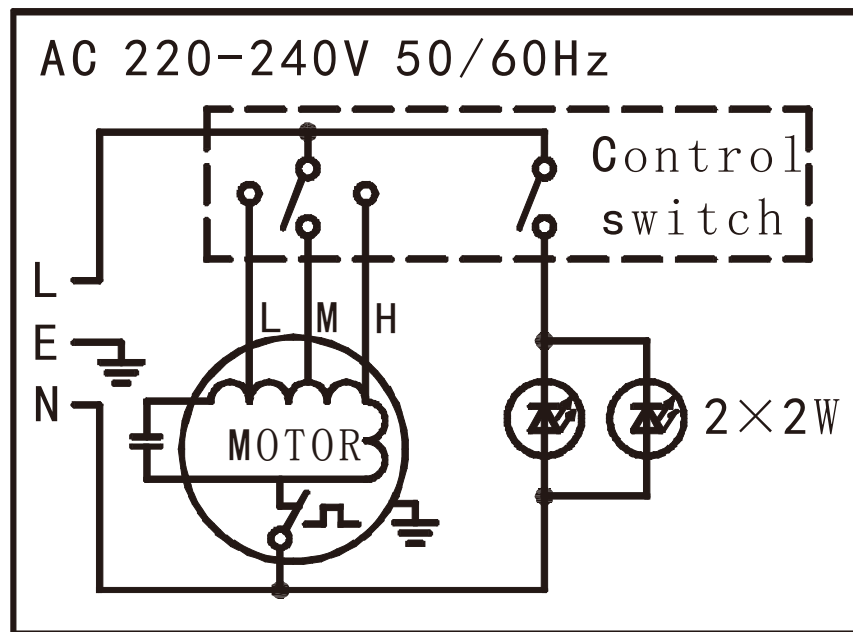

Main Parameters

| | |
|-------------------|--------------------------------|
| Rated Input | 220V-240V, 50Hz |
| Rated Power | 104W |
| Lighting Power | 2W X 2 |
| Motor Power | 100W |
| Drive Mode | Single Motor |
| Speed | Speed I Speed II Speed III |
| Air tube diameter | 150MM |
| Noise | ≤ 56.9 Db(A) |

(9) SERVICE CENTRE

Before calling the Service Centre

If the hood is not working, we recommend that:

- you check the troubleshooting on chapter 8.
- you check that the cooker hood is properly plugged into the power supply

If the cause of the fault cannot be detected:

disconnect the hood from the mains, do not touch the hood and call the after sales service.

Before calling the Service Centre remember to make a note of the serial number on the serial number specifications plate

The hood is supplied with a guarantee certificate that ensures that it will be repaired free of charge at the Service Centre.

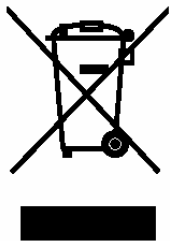

This appliance is marked according to the European directive 2012/19/EU on Waste Electrical and Electronic Equipment (WEEE).

By ensuring this product is disposed of correctly, you will help prevent potential negative consequences for the environment and human health, which could otherwise be caused by inappropriate waste handling of this product.

The symbol on the product indicates that this product may not be treated as household waste. Instead it shall be handed over to the applicable collection point for the recycling of electrical and electronic equipment

Disposal must be carried out in accordance with local environmental regulations for waste disposal.

For more detailed information about treatment, recovery and recycling of this product, please contact your local city office, your household waste disposal service or the shop where you purchased the product.